

IDO/nro nr	LVI-nro/VVS-nr	Paino/Vikt (kg)
92000	5631001	15,5 K
92001	5631006	18,5 K
92002	5631011	21,0 V
92003	5631016	21,0 O
92004	5631021	23,0 V
92005	5631026	23,0 O
92006	5631031	26,0 V
92007	5631036	26,0 K
92008	5631041	26,0 O
92009	5631046	27,5 K
92010	5631051	33,5 2
92011	5631056	30,5 K
92012	5631061	37,0 2

K = allas keskellä bassängen i mitten.
 V = allas vasemmalla bassängen till vänster.
 O = allas oikealla bassängen till höger.
 2 = kaksi allasta två bassänger.

- Pesualtaat valmistetaan ainoastaan valkoisina (-30).
- Tvättställen tillverkas endast i vitt (-30).

Valumarmorinen tasoallas • Heltäckande tvättställ av gjutmarmor

92000 600 x 490 K

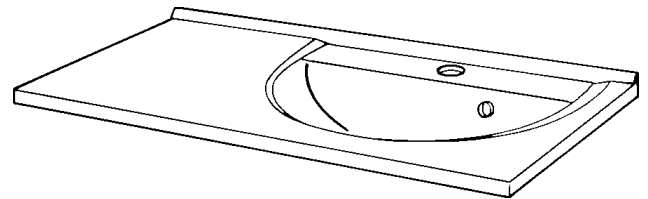
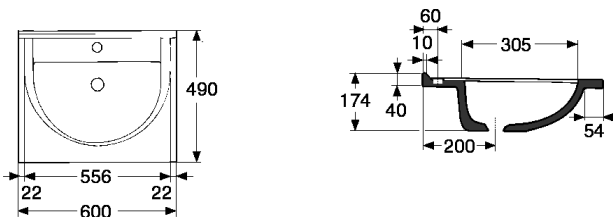

92001 800 x 490 K

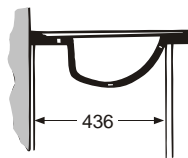
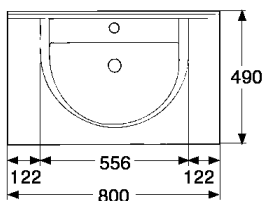

Kaapin min.
sisämitta seinästä.
Skåpets min
innermått från vägg.

- Hanareian koko \varnothing 35 mm.
Etureunan korkeus lattiasta 800-900 mm.
Tasoallas kiinnitetään kaappiin elastisella homesuojatulla massalla.
Kaappiasennus tai kannakeilla tuotenro 61034, pituus 360 mm.

92002 900 x 490 V

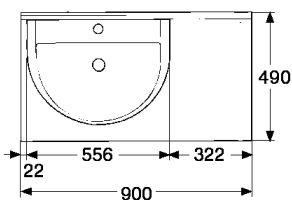

- Kranhålets dimension \varnothing 35 mm.
Framkantens höjd från golv 800-900 mm.
Heltäckande tvättstället fästes på skåp med elastisk mögelresistent massa.
Kan monteras på skåp eller på konsoler produktnr. 61034, längd 360 mm.

92003 900 x 490 O

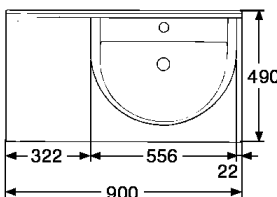

Kannakkeet Konsoler

61034 360 mm

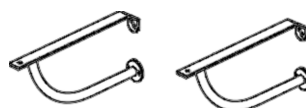

Valumarmorinen tasoallas • Heltäckande tvättställ av gjutmarmor

92004 1000 x 490 V

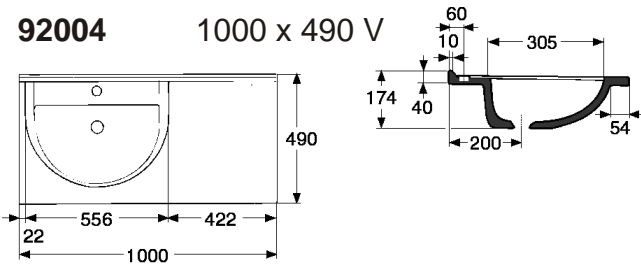

92006 1200 x 490 V

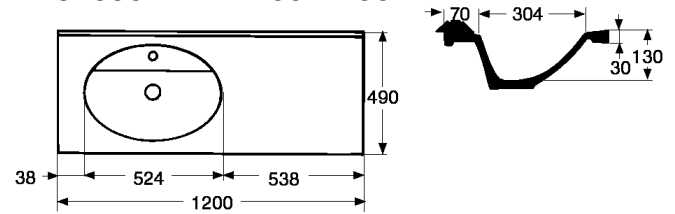

92005 1000 x 490 O

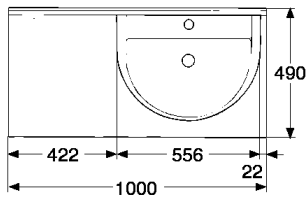

92008 1200 x 490 O

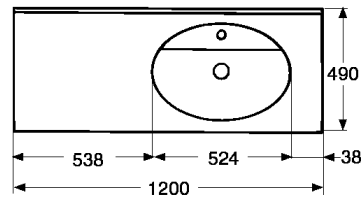

92007 1200 x 490 K

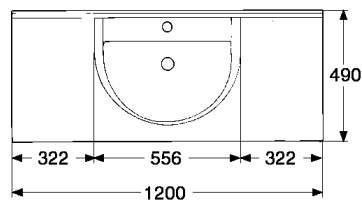

92009-92012 Erikoistilauksesta • På specialbeställning

92009 1400 x 490 K

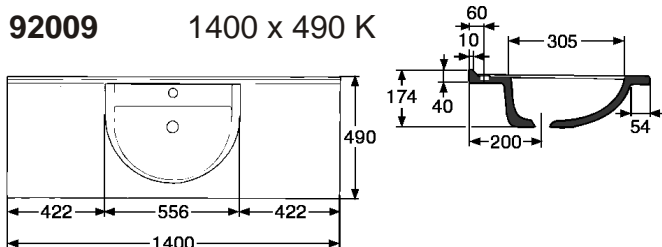

92012 1600 x 490 x 2

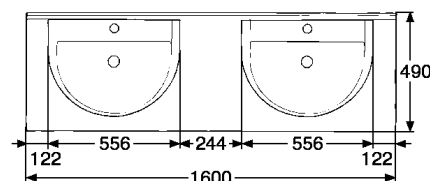

92010 1500 x 490 x 2

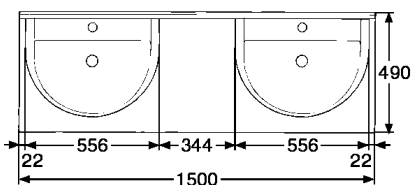

92011 1600 x 490 K

