



## Waste and drainage system

	Description	
<b>Geberit Pipes</b>		→ Page 4
<b>Geberit Fittings</b>	Reducers	→ Page 5
	Bends	→ Page 6
	Sovent	→ Page 9
	Branch and ball fittings	→ Page 10
	Access pipes	→ Page 16
	Electrofusion	→ Page 17
	Sockets	→ Page 18
	Ends	→ Page 19
	Air admittance valves	→ Page 22
	Flanges	→ Page 23
	Connections	→ Page 24
	Sealings for wall and ceilings	→ Page 31
	Fire protection sleeve	→ Page 32
	Adapters for different pipe materials	→ Page 33
	Funnel	→ Page 30
<b>Geberit Conventional roof drainage</b>		→ Page 36
<b>Geberit Fastenings</b>		→ Page 38

## HDPE Pipes

### Geberit HDPE straight lined pipe

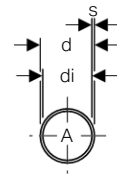
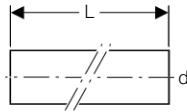
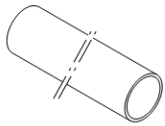

#### Application Purpose

- For all drainage pipes

#### Characteristics

- Tempered according to Geberit standard
- UV-resistant

#### Product Details

Product material	HDPE
------------------	------

#### Scope Of Delivery

- Delivery in sections

#### Ordering Information

Article no.	dØ [mm]	diØ [mm]	s [mm]	A [cm <sup>2</sup> ]	L (m) [m]
379.000.16.0	32	26	3	5,3	5
360.000.16.0	40	34	3	9	5
361.000.16.0	50	44	3	15,2	5
363.000.16.0	56	50	3	19,6	5
364.000.16.0	63	57	3	25,4	5
365.000.16.0	75	69	3	37,3	5
366.000.16.0	90	83	3,5	54,1	5
367.000.16.0	110	101,4	4,3	80,7	5
368.000.16.0	125	115,2	4,9	104,5	5
369.000.16.0	160	147,6	6,2	171,1	5
370.000.16.0	200	187,6	6,2	276,4	5
371.000.16.0	250	234,4	7,8	431,5	5
372.000.16.0	315	295,4	9,8	685,3	5

### Geberit HDPE straight lined pipe PN4

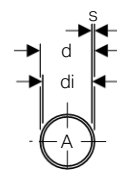
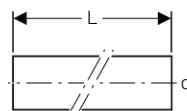
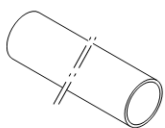

#### Application Purpose

- For all drainage pipes
- For drainage pipes with increased negative pressure

#### Characteristics

- Tempered according to Geberit standard
- UV-resistant

#### Product Details

Product material	HDPE
------------------	------

#### Scope Of Delivery

- Delivery in sections

#### Ordering Information

Article no.	dØ [mm]	diØ [mm]	s [mm]	A [cm <sup>2</sup> ]	L (m) [m]
370.050.16.0	200	184,6	7,7	268,4	5
371.050.16.0	250	230,6	9,7	418,2	5
372.050.16.0	315	290,6	12,2	663,8	5



## HDPE Reducers

### Geberit HDPE concentric reducer, short

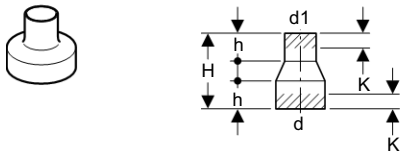

#### Application Purpose

- For all drainage pipes

#### Characteristics

- UV-resistant
- Concentric

#### Product Details

Product material	HDPE
------------------	------

#### Ordering Information

Article no.	dØ [mm]	d1Ø [mm]	H [cm]	h [cm]	K* [cm]
360.557.16.1	40	32	8	3	1,5
361.557.16.1	50	32	8	3	1,5
361.559.16.1	50	40	8	3	1,5
363.559.16.1	56	40	8	3	1,5
363.510.16.1	56	48	4	–	–
363.560.16.1	56	50	8	3	1,5
364.559.16.1	63	40	8	3	1,5
364.560.16.1	63	50	8	3	1,5
364.565.16.1	63	56	8	3	1,5
365.559.16.1	75	40	8	3	1,5
365.560.16.1	75	50	8	3	1,5
365.565.16.1	75	56	8	3	1,5
365.570.16.1	75	63	8	3	1,5
366.559.16.1	90	40	8	3	1,5
366.560.16.1	90	50	8	3	1,5
366.565.16.1	90	56	8	3	1,5
366.570.16.1	90	63	8	3	1,5
366.575.16.1	90	75	8	3	1,5
367.559.16.1	110	40	8	3	1,5
367.560.16.1	110	50	8	3	1,5
367.565.16.1	110	56	8	3	1,5
367.570.16.1	110	63	8	3	1,5
367.575.16.1	110	75	8	3	1,5
367.580.16.1	110	90	8	3	1,5
368.570.16.1	125	63	8	3	1,5
368.575.16.1	125	75	8	3	1,5
368.580.16.1	125	90	8	3	1,5
368.585.16.1	125	110	8	3	1,5
369.535.16.1	160	110	4	0,6	–

\* K indicates the maximum shortening length

### Geberit HDPE eccentric reducer, short

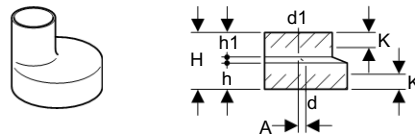

#### Application Purpose

- For all drainage pipes

#### Characteristics

- UV-resistant
- Eccentric

#### Product Details

Product material	HDPE
------------------	------

#### Ordering Information

Article no.	dØ [mm]	d1Ø [mm]	A [cm]	H [cm]	h [cm]	h1 [cm]	K* [cm]
361.558.16.1	50	40	0,5	8	3,7	3,5	2
363.558.16.1	56	40	0,8	8	3,7	3,5	2
363.561.16.1	56	50	0,3	8	3,7	3,5	2
364.558.16.1	63	40	1,15	8	3,7	3,5	2
364.561.16.1	63	50	0,65	8	3,7	3,5	2
364.566.16.1	63	56	0,35	8	3,7	3,5	2
365.558.16.1	75	40	1,75	8	3,7	3,5	2
365.561.16.1	75	50	1,25	8	3,7	3,5	2
365.566.16.1	75	56	0,95	8	3,7	3,5	2
365.571.16.1	75	63	0,6	8	3,7	3,5	2
366.561.16.1	90	50	2	8	3,7	3,5	2
366.566.16.1	90	56	1,7	8	3,7	3,5	2
366.571.16.1	90	63	1,3	8	3,7	3,5	2
366.576.16.1	90	75	0,75	8	3,7	3,5	2
367.558.16.1	110	40	3,4	8	3,7	3,5	2
367.561.16.1	110	50	2,9	8	3,7	3,5	2
367.566.16.1	110	56	2,6	8	3,7	3,5	2
367.571.16.1	110	63	2,2	8	3,7	3,5	2
367.576.16.1	110	75	1,6	8	3,7	3,5	2
367.581.16.1	110	90	0,9	8	3,7	3,5	2
368.561.16.1	125	50	3,6	8	3,7	3,5	2
368.566.16.1	125	56	3,3	8	3,7	3,5	2
368.571.16.1	125	63	2,9	8	3,7	3,5	2
368.576.16.1	125	75	2,3	8	3,7	3,5	2
368.581.16.1	125	90	1,6	8	3,7	3,5	2
368.586.16.1	125	110	0,7	8	3,7	3,5	2
369.586.16.1	160	110	2,3	8	3,5	3,7	2
369.588.16.1	160	125	1,6	8	3,5	3,7	2
369.591.16.1	160	140	1	8	3,5	3,7	2

\* K indicates the maximum shortening length

### Geberit HDPE eccentric reducer, long

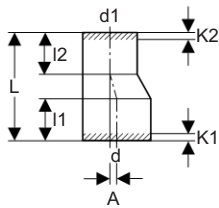
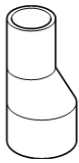

#### Application Purpose

- For all drainage pipes

#### Characteristics

- UV-resistant
- Eccentric

#### Product Details

Product material	HDPE
------------------	------

#### Ordering Information

Article no.	dØ [mm]	d1Ø [mm]	A [cm]	L [cm]	l1 [cm]	l2 [cm]	K1 [cm]	K2 [cm]
368.584.16.1	125	110	0,7	16	7	6,4	4	3
369.584.16.1	160	110	2,5	28	9,4	6,4	6	3
369.587.16.1	160	125	1,7	24	9,4	8	6	5
370.584.16.5	200	110	4,3	28	11,5	3,7	4	0
370.587.16.5	200	125	3,6	28	11,5	3,7	4	0
370.594.16.5	200	160	2	28	11,9	9,1	4	6
371.596.16.1	250	200	2,5	40,5	15,8	15,7	8	8
372.596.16.1	315	200	5,7	58	16,1	15,7	8	8
372.598.16.1	315	250	3,2	43,5	16,1	15,7	8	8

## HDPE Bends

### Geberit HDPE bend 90° long

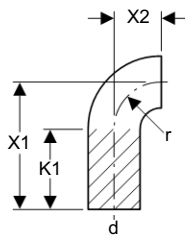

#### Application Purpose

- For all drainage pipes

#### Characteristics

- UV-resistant

#### Product Details

Product material	HDPE
------------------	------

#### Ordering Information

Article no.	dØ [mm]	X1 [cm]	X2 [cm]	K1 [cm]	r [cm]
379.055.16.1	32	10	3	7	3
360.055.16.1	40	15	3	12	3
361.055.16.1	50	18	4	14	4
363.055.16.1	56	21	4	17	4
364.055.16.1	63	21	5	16	5
365.055.16.1	75	21	7	14	7

Article no.	dØ [mm]	X1 [cm]	X2 [cm]	K1 [cm]	r [cm]
366.055.16.1	90	24	9	15	9
367.055.16.1	110	27	10	17	10
368.055.16.1	125	20	11	9	11
369.055.16.1	160	20	14,5	6	14

### Geberit HDPE bend 45°

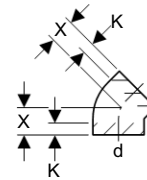

#### Application Purpose

- For all drainage pipes

#### Characteristics

- UV-resistant

#### Product Details

Product material	HDPE
------------------	------

#### Ordering Information

Article no.	dØ [mm]	X [cm]	K* [cm]
360.045.16.1	40	4	2
361.045.16.1	50	4,5	2
363.045.16.1	56	4,5	2
364.045.16.1	63	5	2
365.045.16.1	75	5	2
366.045.16.1	90	5,5	2
367.045.16.1	110	6	2,5
368.045.16.1	125	6,5	2,5
369.045.16.1	160	6,9	2

\* K indicates the maximum shortening length

### Geberit HDPE bend 45° long

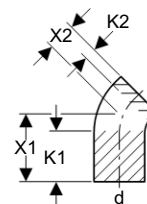

#### Application Purpose

- For all drainage pipes

#### Characteristics

- UV-resistant

#### Product Details

Product material	HDPE
------------------	------

#### Ordering Information

Article no.	dØ [mm]	X1 [cm]	X2 [cm]	K1 [cm]	K2 [cm]
365.046.16.1	75	9,1	5	6	2
367.046.16.1	110	14,7	6	11	2,5



### Geberit HDPE bend 88.5°

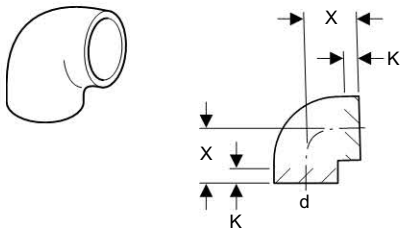

#### Application Purpose

- For all drainage pipes

#### Characteristics

- UV-resistant

#### Product Details

Product material	HDPE
------------------	------

#### Ordering Information

Article no.	dØ [mm]	X [cm]	K* [cm]
361.088.16.1	50	6	2
363.088.16.1	56	6,5	2
364.088.16.1	63	7	2
365.088.16.1	75	7,5	2
366.088.16.1	90	8	2
367.088.16.1	110	9,5	2,5
368.088.16.1	125	10	2,5
369.088.16.1	160	12	2,5

\* K indicates the maximum shortening length

### Geberit HDPE segment bend 30°

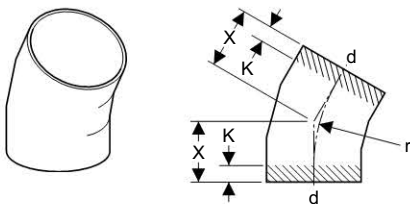

#### Application Purpose

- For all drainage pipes

#### Characteristics

- UV-resistant

#### Product Details

Product material	HDPE
------------------	------

#### Ordering Information

Article no.	dØ [mm]	X [cm]	K* [cm]	r [cm]
370.030.16.1	200	15	2	20
371.030.16.1	250	16	3	42
372.030.16.1	315	17	3	47,3

\* K indicates the maximum shortening length

### Geberit HDPE segment bend 45°

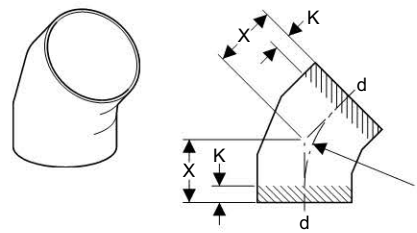

#### Application Purpose

- For all drainage pipes

#### Characteristics

- UV-resistant

#### Product Details

Product material	HDPE
------------------	------

#### Ordering Information

Article no.	dØ [mm]	X [cm]	K* [cm]	r [cm]
370.045.16.1	200	18	2,5	20
371.045.16.1	250	16,5	3	29
372.045.16.1	315	18	3	32,5

\* K indicates the maximum shortening length

### Geberit HDPE segment bend 90°

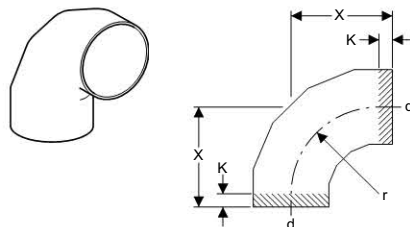

#### Application Purpose

- For all drainage pipes

#### Characteristics

- UV-resistant

#### Product Details

Product material	HDPE
------------------	------

#### Ordering Information

Article no.	dØ [mm]	X [cm]	K* [cm]	r [cm]
370.055.16.1	200	30	2,5	20
371.055.16.1	250	33,5	3	29
372.055.16.1	315	37	3	32,5

\* K indicates the maximum shortening length

**Geberit HDPE bend 90° reduced, without legs**

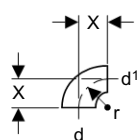

**Application Purpose**

- For all drainage pipes

**Characteristics**

- UV-resistant
- Reduced

**Product Details**

Product material	HDPE
------------------	------

**Ordering Information**

Article no.	dØ [mm]	d1Ø [mm]	X [cm]	r [cm]
361.872.16.1	50	40	4	4
363.873.16.1	56	50	4	4
364.873.16.1	63	50	5	5
364.874.16.1	63	56	5	5



**HDPE Solvent**

**Geberit HDPE Solvent fitting High Flow**

new

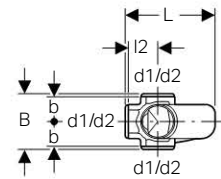
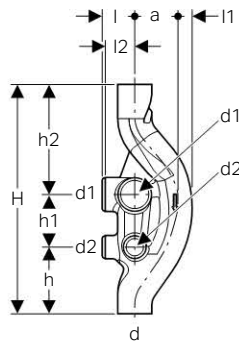

**Application Purpose**

- For all drainage pipes
- For buildings with more than five floors (high-rise buildings)

**Characteristics**

- UV-resistant
- 6 connection possibilities, closed

**Product Details**

Product material	HDPE
------------------	------

**Ordering Information**

Article no.	dØ [mm]	d1Ø [mm]	d2Ø [mm]	a [cm]	B [cm]	b [cm]	H [cm]	h [cm]	h1 [cm]	h2 [cm]	L [cm]	l [cm]	l1 [cm]	l2 [cm]
367.614.16.1	110	110	75	13	18	8	74	21,5	17	35,5	29	10,5	5,5	9,5

**Geberit HDPE Solvent fitting**

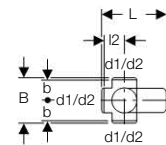
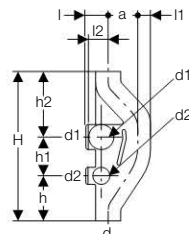

**Application Purpose**

- For all drainage pipes

**Characteristics**

- UV-resistant
- 6 connection possibilities, closed

**Product Details**

Product material	HDPE
------------------	------

**Ordering Information**

Article no.	dØ [mm]	d1Ø [mm]	d2Ø [mm]	a [cm]	B [cm]	b [cm]	H [cm]	h [cm]	h1 [cm]	h2 [cm]	L [cm]	l [cm]	l1 [cm]	l2 [cm]
369.001.16.1	160	110	75	13,3	23	9,5	71	19	17	35	34,3	13	8	11

**HDPE Branch and ball fittings**

**Geberit HDPE double-Y-branch fitting 2 x 30°**

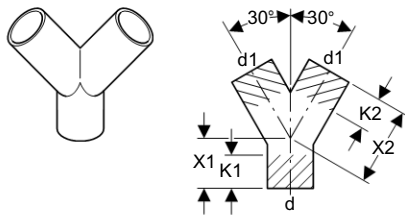

**Application Purpose**

- For all drainage pipes

**Characteristics**

- UV-resistant

**Product Details**

Product material	HDPE
------------------	------

**Ordering Information**

Article no.	dØ [mm]	d1Ø [mm]	X1 [cm]	X2 [cm]	K1 [cm]	K2 [cm]
361.459.16.1	50	40	5,5	11	4	5
361.462.16.1	50	50	5,5	11	3	4
363.462.16.1	56	50	6	12	4	5
363.465.16.1	56	56	1,8	5,3	-	-
364.462.16.1	63	50	6,5	13	5	6
364.465.16.1	63	56	6,5	13	4	6
365.465.16.1	75	56	7	14	6	7
365.470.16.1	75	63	7	14	5	6
367.480.16.1	110	90	9	18	7	7
367.481.16.1	110	110	9	10,2	5	-

**Geberit HDPE multibranch fitting 88.5°, connections 90° offset**

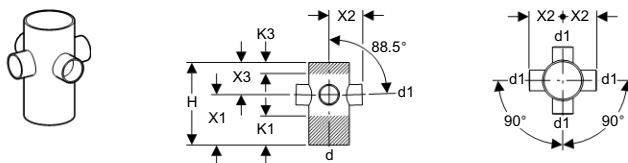

**Application Purpose**

- For all drainage pipes

**Characteristics**

- UV-resistant

**Product Details**

Product material	HDPE
------------------	------

**Ordering Information**

Article no.	dØ [mm]	d1Ø [mm]	X1 [cm]	X2 [cm]	X3 [cm]	H [cm]	K1 [cm]	K3 [cm]
367.445.16.1	110	56	13,5	9	9	22,5	7,5	3

**Geberit HDPE Y-branch fitting 45°**

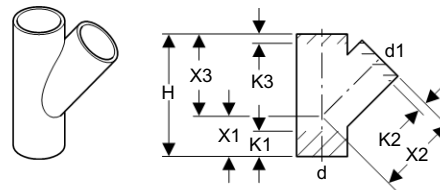

**Application Purpose**

- For all drainage pipes

**Characteristics**

- UV-resistant

**Product Details**

Product material	HDPE
------------------	------

**Ordering Information**

Article no.	dØ [mm]	d1Ø [mm]	X1 [cm]	X2 [cm]	X3 [cm]	H [cm]	K1 [cm]	K2 [cm]	K3 [cm]
379.108.16.1	32	32	3,5	7	7	10,5	2	2	2
360.108.16.1	40	32	4,5	9	9	13,5	3	3,5	3,5
360.109.16.1	40	40	4,5	9	9	13,5	2,5	3	3
361.109.16.1	50	40	5,5	11	11	16,5	4	4,5	4,5
361.112.16.1	50	50	5,5	11	11	16,5	3,5	2	2
363.112.16.1	56	50	6	12	12	18	4	3	3
363.115.16.1	56	56	6	12	12	18	4	2,5	2,5
364.109.16.1	63	40	6,5	13	13	19,5	4,5	4,5	4
364.112.16.1	63	50	6,5	13	13	19,5	5	3	3
364.115.16.1	63	56	6,5	13	13	19,5	4,5	2,5	2,5
364.120.16.1	63	63	6,5	13	13	19,5	4	2	2
365.109.16.1	75	40	7	14	14	21	6,5	5	6
365.112.16.1	75	50	7	14	14	21	6	3	4
365.115.16.1	75	56	7	14	14	21	5,5	2,5	3,5
365.120.16.1	75	63	7	14	14	21	4,5	2,5	3,5
365.125.16.1	75	75	7	14	14	21	4	2,5	2,5
366.109.16.1	90	40	8	16	16	24	7,5	5,5	6,5
366.112.16.1	90	50	8	16	16	24	8	4	5
366.115.16.1	90	56	8	16	16	24	7,5	3,5	4,5
366.120.16.1	90	63	8	16	16	24	7	3	4
366.125.16.1	90	75	8	16	16	24	6,5	3	3,5
366.130.16.1	90	90	8	16	16	24	5	2	2
367.109.16.1	110	40	9	18	18	27	9,5	6	7,5
367.112.16.1	110	50	9	18	18	27	9,5	5	5,5
367.115.16.1	110	56	9	18	18	27	9	4	4,5
367.120.16.1	110	63	9	18	18	27	8,5	3,5	4
367.125.16.1	110	75	9	18	18	27	7,5	3	3,5
367.130.16.1	110	90	9	18	18	27	6,5	2,5	3
367.135.16.1	110	110	9	18	18	27	5,5	2	2
368.120.16.1	125	63	10	20	20	30	10,5	4,5	6
368.125.16.1	125	75	10	20	20	30	9,5	4	5
368.130.16.1	125	90	10	20	20	30	8,5	3	3,5
368.135.16.1	125	110	10	20	20	30	7	2,5	2,5
368.139.16.1	125	125	10	20	20	30	6	2	2
369.125.16.1	160	75	12,5	25	25	37,5	13,5	6,5	7,5
369.130.16.1	160	90	12,5	25	25	37,5	12,5	5,5	6,5
369.135.16.1	160	110	12,5	25	25	37,5	11	4,5	5,5
369.139.16.1	160	125	12,5	25	25	37,5	10	4	5
369.145.16.1	160	160	12,5	25	25	37,5	7,5	2,5	2,5
370.125.16.1	200	75	18	36	36	54	18	14	12





Article no.	dØ [mm]	d1Ø [mm]	X1 [cm]	X2 [cm]	X3 [cm]	H [cm]	K1 [cm]	K2 [cm]	K3 [cm]
370.135.16.1	200	110	18	36	36	54	15	14	6,5
370.139.16.1	200	125	18	36	36	54	14	13	5,5
370.145.16.1	200	160	18	36	36	54	11,5	8,5	3,5
370.146.16.1	200	200	18	36	36	54	8,5	1	1
371.135.16.1	250	110	22	44	44	66	21,5	13,5	15
371.139.16.1	250	125	22	44	44	66	20,5	17,5	14
371.145.16.1	250	160	22	44	44	66	18	13	5
371.146.16.1	250	200	22	44	44	66	15	5	9
371.147.16.1	250	250	22	44	44	66	11,5	5,5	5,5
372.135.16.1	315	110	28	56	56	84	30,5	26	23,5
372.139.16.1	315	125	28	56	56	84	29	25	22
372.145.16.1	315	160	28	56	56	84	27	20,5	20
372.146.16.1	315	200	28	56	56	84	24	12,5	17,5
372.147.16.1	315	250	28	56	56	84	20,5	13	14
372.148.16.1	315	315	28	56	56	84	16	9,5	9,5

### Geberit HDPE double-Y-branch fitting 2 x 45° with connections 180° offset

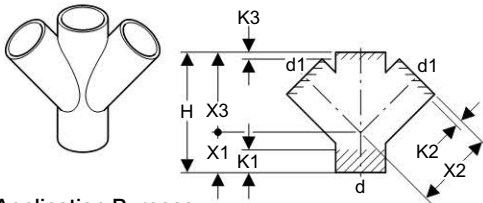

#### Application Purpose

- For all drainage pipes
- For vertical installation

#### Characteristics

- UV-resistant

#### Product Details

Product material	HDPE
------------------	------

#### Ordering Information

Article no.	dØ [mm]	d1Ø [mm]	X1 [cm]	X2 [cm]	X3 [cm]	H [cm]	K1 [cm]	K2 [cm]	K3 [cm]
367.209.16.1	110	40	9	18	18	27	9,5	6	7,5
367.212.16.1	110	50	9	18	18	27	9,5	6	7,5
367.235.16.1	110	110	9	18	18	27	5	1,5	1,5

### Geberit HDPE branch fitting 88.5°, swept-entry

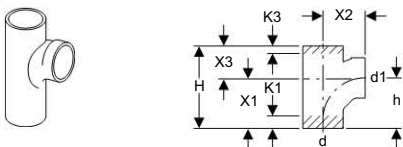

#### Application Purpose

- For all drainage pipes

#### Characteristics

- UV-resistant

#### Product Details

Product material	HDPE
------------------	------

#### Ordering Information

Article no.	dØ [mm]	d1Ø [mm]	X1 [cm]	X2 [cm]	X3 [cm]	H [cm]	h [cm]	K1 [cm]	K3 [cm]
367.163.16.1	110	110	13,5	11,5	9	22,5	13,8	3,5	3,5

Geberit HDPE branch fitting 88.5°

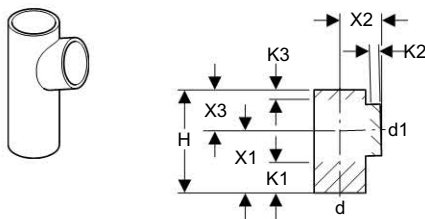

Application Purpose

- For all drainage pipes

Characteristics

- UV-resistant

Product Details

Product material	HDPE
------------------	------

Ordering Information

Article no.	dØ [mm]	d1Ø [mm]	X1 [cm]	X2 [cm]	X3 [cm]	H [cm]	K1 [cm]	K2 [cm]	K3 [cm]
379.158.16.1	32	32	5	3,5	3,5	8,5	2,5	1	1
360.158.16.1	40	32	7,5	5,5	5,5	13	5	2,5	2
360.159.16.1	40	40	7,5	5,5	5,5	13	4,5	2,5	2,5
361.159.16.1	50	40	9	6	6	15	6	2,5	3
361.162.16.1	50	50	9	6	6	15	5,5	2,5	2,5
363.162.16.1	56	50	10,5	7	7	17,5	7	3	3,5
363.165.16.1	56	56	10,5	7	7	17,5	6,5	3	3
364.159.16.1	63	40	10,5	7	7	17,5	7	3	3
364.162.16.1	63	50	10,5	7	7	17,5	7	3	3,5
364.165.16.1	63	56	10,5	7	7	17,5	6,5	3	3
364.170.16.1	63	63	10,5	7	7	17,5	6	3	3
365.159.16.1	75	40	10,5	7	7	17,5	7,5	2,5	4
365.162.16.1	75	50	10,5	7	7	17,5	7	2,5	3,5
365.165.16.1	75	56	10,5	7	7	17,5	6,5	2,5	3
365.170.16.1	75	63	10,5	7	7	17,5	6	2,5	2,5
365.175.16.1	75	75	10,5	7	7	17,5	5,5	2,5	2,5
366.159.16.1	90	40	12	8	8	20	8,5	2,5	4,5
366.162.16.1	90	50	12	8	8	20	8,5	2,5	4,5
366.165.16.1	90	56	12	8	8	20	8	2,5	4
366.170.16.1	90	63	12	8	8	20	7,5	2,5	3,5
366.175.16.1	90	75	12	8	8	20	7	2,5	3
366.180.16.1	90	90	12	8	8	20	6,5	2,5	2,5
367.159.16.1	110	40	13,5	9	9	22,5	10	2,5	6
367.162.16.1	110	50	13,5	9	9	22,5	9,5	2,5	5
367.165.16.1	110	56	13,5	9	9	22,5	9	2,5	4,5
367.170.16.1	110	63	13,5	9	9	22,5	9	2,5	4
367.175.16.1	110	75	13,5	9	9	22,5	8,5	2,5	3,5
367.180.16.1	110	90	13,5	9	9	22,5	7,5	2,5	3
367.185.16.1	110	110	13,5	9	9	22,5	6,5	2	2
368.162.16.1	125	50	15	10	10	25	11	2,5	6
368.165.16.1	125	56	15	10	10	25	10,5	2,5	5,5
368.170.16.1	125	63	15	10	10	25	10,5	2,5	5
368.175.16.1	125	75	15	10	10	25	10	2,5	4,5
368.180.16.1	125	90	15	10	10	25	9	2,5	4
368.185.16.1	125	110	15	10	10	25	8	2	3
368.189.16.1	125	125	15	10	10	25	7	2	2
369.175.16.1	160	75	21	14	14	35	15	4,5	8

Article no.	dØ [mm]	d1Ø [mm]	X1 [cm]	X2 [cm]	X3 [cm]	H [cm]	K1 [cm]	K2 [cm]	K3 [cm]
369.185.16.1	160	110	21	14	14	35	13,5	4,5	6
369.195.16.1	160	160	21	14	14	35	10,5	3,5	3
370.180.16.1	200	90	18	18	18	36	7	6	7
370.185.16.1	200	110	18	18	18	36	7	6	7
370.195.16.1	200	160	18	18	18	36	4,5	5	4,5
370.196.16.1	200	200	20	20	20	40	2,5	3	2,5
371.185.16.1	250	110	22	22	22	44	11	7,5	11
371.189.16.1	250	125	22	22	22	44	10,5	7,5	10,5
371.195.16.1	250	160	22	22	22	44	8,5	6,5	8,5
371.196.16.1	250	200	24	24	24	48	6,5	4	6,5
371.197.16.1	250	250	24	24	24	48	4	4	4
372.185.16.1	315	110	28	28	28	56	17	10	17
372.189.16.1	315	125	28	28	28	56	16,5	10	16,5
372.195.16.1	315	160	28	28	28	56	14,5	9	14,5
372.196.16.1	315	200	28	28	28	56	12	6,5	12
372.197.16.1	315	250	28	28	28	56	9,5	6,5	9,5
372.198.16.1	315	315	28	28	28	56	7	6,5	7

Geberit HDPE waste manifold

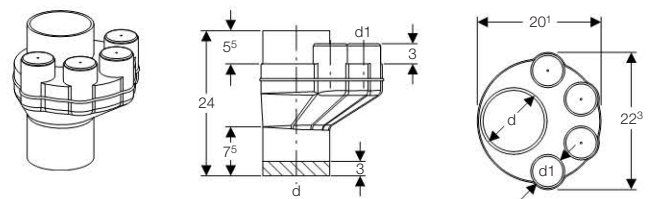

Application Purpose

- For all drainage pipes

Characteristics

- UV-resistant
- 4 connection possibilities dia. 56 mm, sealed

Product Details

Product material	HDPE
------------------	------

Ordering Information

Article no.	dØ [mm]	d1Ø [mm]	Colour
367.612.16.1	110	56	black



**Geberit HDPE double branchball fitting 88.5°, connections 180° offset**

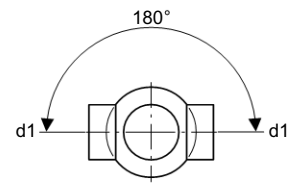
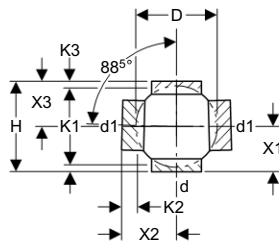

**Application Purpose**

- For all drainage pipes

**Characteristics**

- UV-resistant

**Product Details**

Product material	HDPE
------------------	------

**Ordering Information**

Article no.	dØ [mm]	d1Ø [mm]	D [cm]	X1 [cm]	X2 [cm]	X3 [cm]	H [cm]	K1 [cm]	K2 [cm]	K3 [cm]
364.270.16.1	63	63	10	8	10	8	16	1,5	4,5	1,5
365.275.16.1	75	75	12	8	10	8	16	1,5	3,5	1,5
366.280.16.1	90	90	14	9	11	9	18	2	4	2
367.262.16.1	110	50	17	10	12	10	20	1,5	1,5	1,5
367.265.16.1	110	56	17	10	12	10	20	1,5	1,5	1,5
367.270.16.1	110	63	17	10	12	10	20	1,5	1,5	1,5
367.275.16.1	110	75	17	10	12	10	20	1,5	1,5	1,5
367.280.16.1	110	90	17	10	12	10	20	1,5	1,5	1,5
367.285.16.1	110	110	17	10	12	10	20	1,5	4	1,5
368.285.16.1	125	110	18	10	12,5	10	20	1,5	4	1,5
369.285.16.1	160	110	23	12,5	16	12,5	25	2	1,5	2

**Geberit HDPE double branchball 88.5°, connections 90° offset**

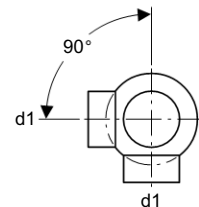
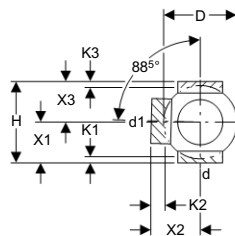

**Application Purpose**

- For all drainage pipes

**Characteristics**

- UV-resistant

**Product Details**

Product material	HDPE
------------------	------

**Ordering Information**

Article no.	dØ [mm]	d1Ø [mm]	D [cm]	X1 [cm]	X2 [cm]	X3 [cm]	H [cm]	K1 [cm]	K2 [cm]	K3 [cm]
364.320.16.1	63	63	10	8	10	8	16	1,5	4,5	1,5
365.325.16.1	75	75	12	8	10	8	16	1,5	3,5	1,5
366.330.16.1	90	90	14	9	11	9	18	2	4	2
367.315.16.1	110	56	17	10	12	10	20	1,5	1,5	1,5
367.320.16.1	110	63	17	10	12	10	20	1,5	1,5	1,5
367.325.16.1	110	75	17	10	12	10	20	1,5	1,5	1,5
367.330.16.1	110	90	17	10	12	10	20	1,5	1,5	1,5
367.335.16.1	110	110	17	10	12	10	20	1,5	4	1,5
368.335.16.1	125	110	18	10	12,5	10	20	1,5	4	1,5
369.335.16.1	160	110	23	12,5	16	12,5	25	2	1,5	2

Geberit HDPE double branchball 88.5°, connections 135° offset

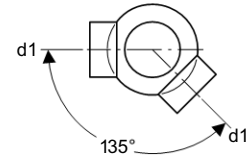
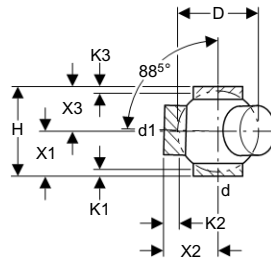

Application Purpose

- For all drainage pipes

Characteristics

- UV-resistant

Product Details

Product material	HDPE
------------------	------

Ordering Information

Article no.	dØ [mm]	d1Ø [mm]	D [cm]	X1 [cm]	X2 [cm]	X3 [cm]	H [cm]	K1 [cm]	K2 [cm]	K3 [cm]
364.370.16.1	63	63	10	8	10	8	16	1,5	4,5	1,5
365.375.16.1	75	75	12	8	10	8	16	1,5	3,5	1,5
366.380.16.1	90	90	14	9	11	9	18	2	4	2
367.362.16.1	110	50	17	10	12	10	20	1,5	1,5	1,5
367.365.16.1	110	56	17	10	12	10	20	1,5	1,5	1,5
367.370.16.1	110	63	17	10	12	10	20	1,5	1,5	1,5
367.375.16.1	110	75	17	10	12	10	20	1,5	1,5	1,5
367.380.16.1	110	90	17	10	12	10	20	1,5	1,5	1,5
367.385.16.1	110	110	17	10	12	10	20	1,5	4	1,5
368.385.16.1	125	110	18	10	12,5	10	20	1,5	4	1,5
369.385.16.1	160	110	23	12,5	16	12,5	25	2	1,5	2

Geberit HDPE triple branchball fitting 88.5°, connections 135° offset

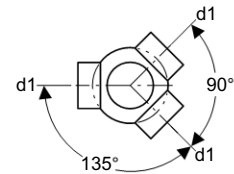
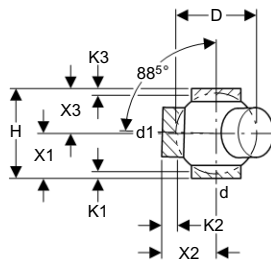

Application Purpose

- For all drainage pipes

Characteristics

- UV-resistant

Product Details

Product material	HDPE
------------------	------

Ordering Information

Article no.	dØ [mm]	d1Ø [mm]	D [cm]	X1 [cm]	X2 [cm]	X3 [cm]	H [cm]	K1 [cm]	K2 [cm]	K3 [cm]
364.600.16.1	63	63	10	8	10	8	16	1,5	4,5	1,5
365.600.16.1	75	75	12	8	10	8	16	1,5	3,5	1,5
367.600.16.1	110	110	17	10	12	10	20	1,5	4	1,5
368.600.16.1	125	110	18	10	12	10	20	1,5	4	1,5



**Geberit HDPE triple branchball fitting 88.5°, connections 90° offset**

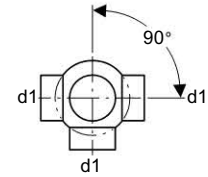
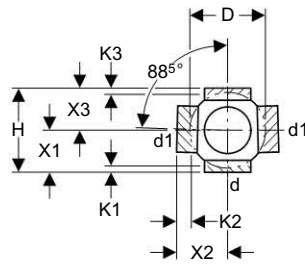

**Application Purpose**

- For all drainage pipes

**Characteristics**

- UV-resistant

**Product Details**

Product material	HDPE
------------------	------

**Ordering Information**

Article no.	dØ [mm]	d1Ø [mm]	D [cm]	X1 [cm]	X2 [cm]	X3 [cm]	H [cm]	K1 [cm]	K2 [cm]	K3 [cm]
364.605.16.1	63	63	10	8	10	8	16	1,5	4,5	1,5
365.605.16.1	75	75	12	8	10	8	16	1,5	3,5	1,5
366.605.16.1	90	90	14	9	11	9	18	2	4	2
367.605.16.1	110	110	17	10	12	10	20	1,5	4	1,5
368.605.16.1	125	110	18	10	12	10	20	1,5	4	1,5
369.605.16.1	160	110	23	12,5	16	12,5	25	2	1,5	2

**Geberit HDPE multi-branchball fitting 88.5°, connections 90° offset**

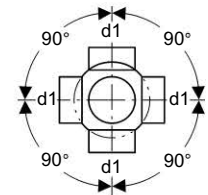
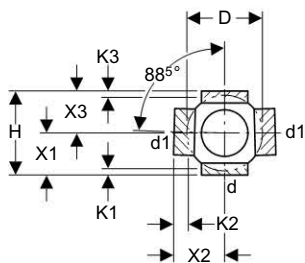

**Application Purpose**

- For all drainage pipes

**Characteristics**

- UV-resistant

**Product Details**

Product material	HDPE
------------------	------

**Ordering Information**

Article no.	dØ [mm]	d1Ø [mm]	D [cm]	X1 [cm]	X2 [cm]	X3 [cm]	H [cm]	K1 [cm]	K2 [cm]	K3 [cm]
364.610.16.1	63	63	10	8	10	8	16	1,5	4,5	1,5
365.610.16.1	75	75	12	8	10	8	16	1,5	3,5	1,5
367.610.16.1	110	110	17	10	12	10	20	1,5	4	1,5
368.610.16.1	125	110	18	10	12,5	10	20	1,5	4	1,5

## HDPE Access pipes

### Geberit HDPE access pipe 90° with round access cover

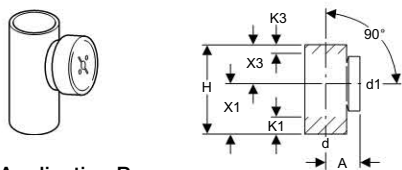

#### Application Purpose

- For all drainage pipes
- For cleaning and inspection of pipe sections

#### Characteristics

- UV-resistant
- Round opening

#### Product Details

Product material	HDPE
------------------	------

#### Scope Of Delivery

- Sealing cap PP
- Seal EPDM

#### Ordering Information

Article no.	dØ [mm]	d1Ø [mm]	A [cm]	X1 [cm]	X3 [cm]	H [cm]	K1 [cm]	K3 [cm]
364.451.16.1	63	63	9	10,5	7	17,5	4,5	1
365.451.16.1	75	75	9,5	10,5	7	17,5	3,5	-
366.451.16.1	90	90	11	12	8	20	3	-
367.451.16.1	110	110	9	13,5	10,5	24	4,5	-
368.451.16.1	125	110	13	15	10	25	6	1
369.451.16.1	160	110	15	21	14	35	12	4

### Geberit HDPE access pipe 45° with round access cover

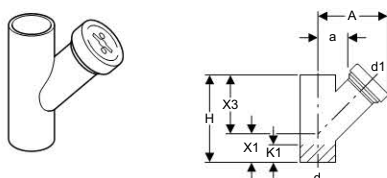

#### Application Purpose

- For all drainage pipes
- For cleaning and inspection of pipe sections

#### Characteristics

- UV-resistant
- Round opening

#### Product Details

Product material	HDPE
------------------	------

#### Scope Of Delivery

- Sealing cap PP
- Seal EPDM

#### Ordering Information

Article no.	dØ [mm]	d1Ø [mm]	A [cm]	a [cm]	X1 [cm]	X3 [cm]	H [cm]	K1 [cm]
367.453.16.1	110	110	19,5	6,5	9	18	27	5,5
368.453.16.1	125	110	20	7	10	20	30	7
369.453.16.1	160	110	22	9	12,5	25	37,5	11

### Geberit HDPE access pipe 90° with oval access cover

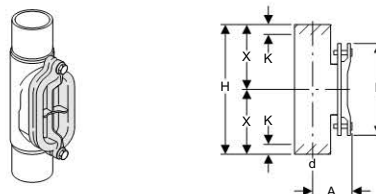

#### Application Purpose

- For all drainage pipes
- For cleaning and inspection of pipe sections

#### Characteristics

- UV-resistant
- Oval opening

#### Product Details

Product material	HDPE
------------------	------

#### Scope Of Delivery

- Seal EPDM
- Steel cover, HDPE coated

#### Ordering Information

Article no.	dØ [mm]	A [cm]	X [cm]	H [cm]	h [cm]	K* [cm]
367.454.16.1	110	12	20	40	28	3
368.454.16.1	125	12,5	20,5	41	28	4
369.454.16.1	160	14	21,5	43	28	4
370.454.16.1	200	17,5	32,5	65	38	5,5
371.454.16.1	250	20	29	58	38	3
372.454.16.1	315	23	31	62	38	8

\* K indicates the maximum shortening length



## HDPE Electrofusion

### Geberit electrofusion sleeve coupling

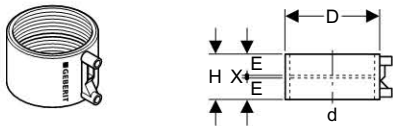

#### Application Purpose

- For all drainage pipes
- For plugging or pushing onto pipes and fittings
- For tension resistant connection of pipes and fittings

#### Characteristics

- UV-resistant
- Can be welded with Geberit electrofusion machine ESG 40/200

#### Product Details

Product material	HDPE
------------------	------

#### Ordering Information

Article no.	dØ [mm]	D [cm]	E [cm]	X [cm]	H [cm]
360.771.16.1	40	5,2	2,8	0,3	6
361.771.16.1	50	6,2	2,8	0,3	6
363.771.16.1	56	6,8	2,8	0,3	6
364.771.16.1	63	7,6	2,8	0,3	6
365.771.16.1	75	8,9	2,8	0,3	6
366.771.16.1	90	10,4	2,8	0,3	6
367.771.16.1	110	12,5	2,8	0,3	6
368.771.16.1	125	14,2	2,8	0,3	6
312.771.16.1	135	15	2,8	0,3	6
369.771.16.1	160	17,8	2,8	0,3	6

### Geberit electrofusion coupling with integrated thermal fuse

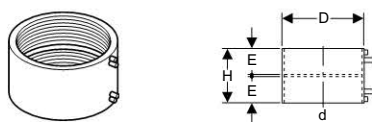

#### Application Purpose

- For all drainage pipes
- For plugging or pushing onto pipes and fittings
- For tension resistant connection of pipes and fittings

#### Characteristics

- UV-resistant
- Integrated heat fuse
- Can be welded with Geberit start switch ESG-T2
- Heat-insulated

#### Product Details

Product material	HDPE
------------------	------

#### Ordering Information

Article no.	dØ [mm]	D [cm]	E [cm]	H [cm]
370.775.16.1	200	22,4	7,5	15
371.775.16.1	250	27,5	7,5	15
372.775.16.1	315	34,3	7,5	15

### Geberit electrofusion tape for anchor bracket

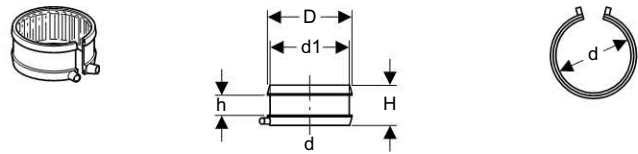

#### Application Purpose

- For anchor-point fastening of pipes in conjunction with pipe brackets

#### Characteristics

- 1-section
- Can be welded with Geberit electrofusion machine ESG 40/200

#### Product Details

Product material	PE
------------------	----

#### Ordering Information

Article no.	dØ [mm]	d1Ø [mm]	D [cm]	H [cm]	h [cm]
361.776.16.1	50	58	6,6	6	3
363.776.16.1	56	64	7,2	6	3
364.776.16.1	63	71	7,9	6	3
365.776.16.1	75	83	9,1	6	3
366.776.16.1	90	98	10,6	6	3
367.776.16.1	110	118	12,6	6	3
368.776.16.1	125	133	14,1	6	3
369.776.16.1	160	168	17,6	6	3
370.776.16.1	200	208	21,6	6	3
371.776.16.1	250	258	26,6	6	3

### Set Geberit electrofusion tape for anchor bracket (2-piece)

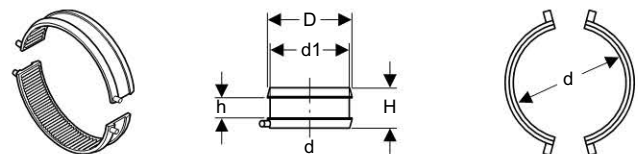

#### Application Purpose

- For anchor-point fastening of pipes in conjunction with pipe brackets

#### Characteristics

- 2-sections
- Can be welded with Geberit electrofusion machine ESG 40/200

#### Product Details

Product material	PE
------------------	----

#### Ordering Information

Article no.	dØ [mm]	d1Ø [mm]	D [cm]	H [cm]	h [cm]
372.776.16.1	315	323	33,1	6	3

## HDPE Sockets

### Geberit HDPE expansion socket with double flange

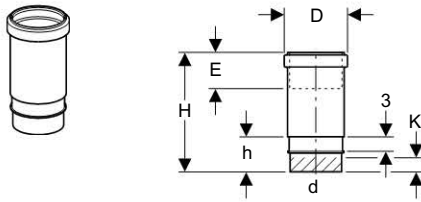

#### Application Purpose

- For all drainage pipes

#### Characteristics

- UV-resistant
- Double flange bushing, rim for anchor bracket

#### Product Details

Product material	HDPE
------------------	------

#### Scope Of Delivery

- Lip seal EPDM
- Protection cap

#### Ordering Information

Article no.	dØ [mm]	D [cm]	E [cm]	H [cm]	h [cm]	l [cm]	K [cm]
379.791.16.1	32	4,8	7 - 10,5	8,5	1	3	0
360.700.16.1	40	7	7 - 10,5	23,3	6,5	3	3
361.700.16.1	50	8	7 - 10,5	23,3	6,5	3	3
363.700.16.1	56	8,6	7 - 10,5	23,3	6,5	3	3
364.700.16.1	63	9,3	7 - 10,5	23,3	6,5	3	3
365.700.16.1	75	10,8	7 - 10,5	23,9	7,4	3	3
366.700.16.1	90	12,4	7 - 10,5	23,9	7,5	3	3
367.700.16.1	110	13,5	7 - 10,5	25,5	8	3	3,5
368.700.16.1	125	16,2	7 - 10,5	23,9	6,5	3	3,5
369.700.16.1	160	20,2	7 - 10,5	24	7	3	3,5

### Geberit HDPE expansion socket

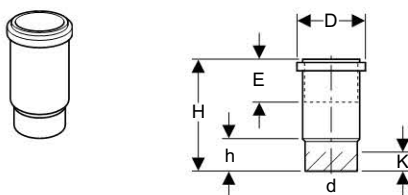

#### Application Purpose

- For all drainage pipes
- For horizontal and vertical installation

#### Characteristics

- UV-resistant

#### Product Details

Product material	HDPE
------------------	------

#### Scope Of Delivery

- Lip seal EPDM
- Protection cap

#### Ordering Information

Article no.	dØ [mm]	D [cm]	E [cm]	H [cm]	h [cm]	K [cm]
370.700.16.1	200	25	17 - 20,5	40	12,5	11
371.700.16.1	250	29,1	17 - 20,5	42,5	17	14
372.700.16.1	315	36,1	17 - 20,5	45,8	17,5	14

### Geberit HDPE ring seal socket

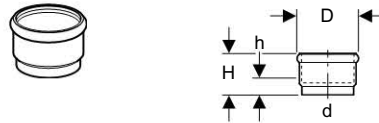

#### Application Purpose

- For all drainage pipes

#### Characteristics

- UV-resistant

#### Product Details

Product material	HDPE
------------------	------

#### Scope Of Delivery

- Lip seal EPDM
- Protection cap

#### Ordering Information

Article no.	dØ [mm]	D [cm]	H [cm]	h [cm]
360.779.16.1	40	5,7	6,3	2
361.779.16.1	50	6,7	6,3	2
363.779.16.1	56	7,2	6,4	2
364.779.16.1	63	8	6,5	2
365.779.16.1	75	9,2	8,8	2,5
366.779.16.1	90	10,8	8,8	2,5
367.779.16.1	110	13,1	8,8	2,5
368.779.16.1	125	14,9	8,8	2,5
369.779.16.1	160	18,8	12,3	3

### Geberit HDPE ring seal socket, reduced

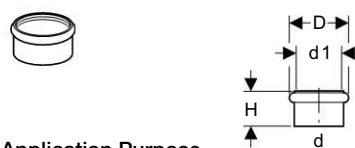

#### Application Purpose

- For all drainage pipes

#### Characteristics

- UV-resistant
- Reduced

#### Product Details

Product material	HDPE
------------------	------

#### Scope Of Delivery

- Lip seal EPDM
- Protection cap

#### Ordering Information

Article no.	dØ [mm]	d1Ø [mm]	D [cm]	H [cm]
361.752.16.1	57	50	6,7	4
364.752.16.1	63	56	7,2	4,4





### Geberit HDPE connection ring seal socket

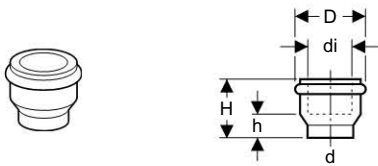

#### Application Purpose

- For all drainage pipes

#### Characteristics

- UV-resistant

#### Product Details

Product material	HDPE
------------------	------

#### Scope Of Delivery

- Lip seal EPDM
- Protection plug

#### Ordering Information

Article no.	dØ [mm]	diØ [mm]	D [cm]	H [cm]	h [cm]
379.768.16.1	32	32	4,6	2,5	0,5

### Geberit HDPE adapter sleeve

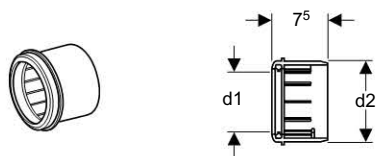

#### Application Purpose

- For all drainage pipes

#### Characteristics

- UV-resistant

#### Product Details

Product material	HDPE
------------------	------

#### Scope Of Delivery

- Lip seal EPDM

#### Ordering Information

Article no.	d1Ø [mm]	d2Ø [mm]
367.928.16.1	90	110

### HDPE Ends

### Geberit HDPE complete stop end



#### Application Purpose

- For all drainage pipes
- For cleaning and inspection of pipe sections

#### Characteristics

- UV-resistant
- Round opening

#### Product Details

Product material	HDPE
------------------	------

#### Scope Of Delivery

- Sealing cap PP
- Seal EPDM

#### Ordering Information

Article no.	dØ [mm]	Rg [mm/in]	D [cm]	H [cm]
367.471.16.1	110	130 x 1/4	14,3	4

### Geberit HDPE threaded connector end with union nut

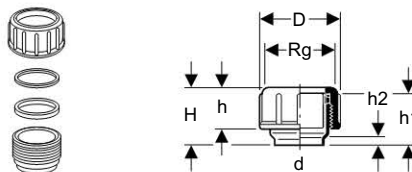

#### Application Purpose

- For all drainage pipes

#### Characteristics

- UV-resistant

#### Product Details

Product material	HDPE
------------------	------

#### Scope Of Delivery

- Union nut PP
- Slip ring PP
- Seal EPDM
- Protective cap

#### Ordering Information

Article no.	dØ [mm]	Rg [mm/in]	D [cm]	H [cm]	h [cm]	h1 [cm]	h2 [cm]
379.740.16.1	32	44 x 1/8	5,6	4,5	2,6	3	1
360.740.16.1	40	52 x 1/6	6,4	6,3	3,3	5	2
361.740.16.1	50	62 x 1/6	7,4	6,3	3,3	5	2
363.740.16.1	56	70 x 1/6	8,5	6,8	3,5	5	2
364.740.16.1	63	75 x 1/6	9	6,8	4,2	5	2
365.740.16.1	75	95 x 1/6	11,2	9,6	4,5	7,5	2,5
366.740.16.1	90	110 x 1/4	12,9	9,7	5	7,5	2,5
367.740.16.1	110	130 x 1/4	14,9	9,7	6,5	7,5	2,5

### Geberit HDPE union nut

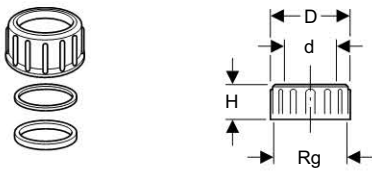

#### Application Purpose

- For all drainage pipes

#### Scope Of Delivery

- Seal EPDM
- Slip ring PP

#### Ordering Information

Article no.	dØ [mm]	Rg [mm/in]	D [cm]	H [cm]
363.749.16.1	56	70 x 1/6	8,5	6,8
364.749.16.1	63	75 x 1/6	9	6,8

### Geberit HDPE threaded connector end with screw cap

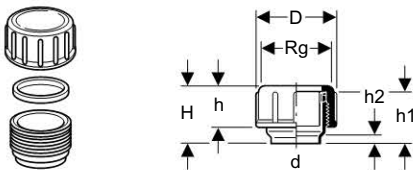

#### Application Purpose

- For all drainage pipes

#### Characteristics

- UV-resistant

#### Product Details

Product material	HDPE
------------------	------

#### Scope Of Delivery

- Sealing cap PP
- Seal EPDM

#### Ordering Information

Article no.	dØ [mm]	Rg [mm/in]	D [cm]	H [cm]	h [cm]	h1 [cm]	h2 [cm]
379.750.16.1	32	44 x 1/8	5,6	4,5	2,6	3	1
360.750.16.1	40	52 x 1/6	6,4	6,3	3,3	5	2
361.750.16.1	50	62 x 1/6	7,4	6,3	3,3	5	2
363.750.16.1	56	70 x 1/6	8,5	6,8	3,5	5	2
364.750.16.1	63	75 x 1/6	9	6,8	4,2	5	2
365.750.16.1	75	95 x 1/6	11,2	9,6	4,5	7,5	2,5
366.750.16.1	90	110 x 1/4	12,9	9,7	4,8	7,5	2,5
367.750.16.1	110	130 x 1/4	14,9	9,7	6,3	7,5	2,5

### Geberit straight connector with screw connection

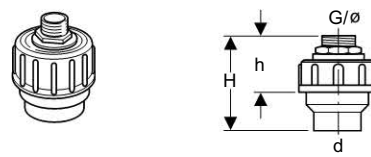

#### Characteristics

- With union

#### Scope Of Delivery

- With brass nipple
- Seal

#### Ordering Information

Article no.	dØ [mm]	G ["]	H [cm]	h [cm]
152.973.00.1	40	1/2	9	6
152.974.00.1	40	3/4	9	6
152.978.00.1	50	1	9	6
152.979.00.1	50	1/2	9	6
152.981.00.1	50	3/4	9	6

### Geberit HDPE flange bushing

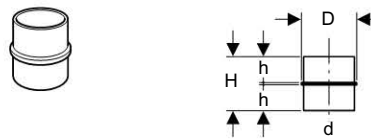

#### Application Purpose

- For all drainage pipes

#### Characteristics

- UV-resistant

#### Product Details

Product material	HDPE
------------------	------

#### Ordering Information

Article no.	dØ [mm]	D [cm]	H [cm]	h [cm]
379.772.16.1	32	3,8	5,2	2,4
360.772.16.1	40	4,7	6,8	3,2
361.772.16.1	50	5,7	6,8	3,2
363.772.16.1	56	6,5	5,8	2,7
364.772.16.1	63	7	7,2	3,4
365.772.16.1	75	9	7,2	3,4
366.772.16.1	90	10,3	9,2	4,4
367.772.16.1	110	12	11,7	5,6



## Geberit HDPE cap for butt welding



### Application Purpose

- For all drainage pipes
- For butt welding

### Characteristics

- UV-resistant

### Product Details

Product material	HDPE
------------------	------

### Ordering Information

Article no.	Description	dØ [mm]
379.812.16.1	Geberit HDPE cap for butt welding, dia. 32 mm	32
360.812.16.1	Geberit HDPE cap for butt welding, dia. 40 mm	40
361.812.16.1	Geberit HDPE cap for butt welding, dia. 50 mm	50
363.812.16.1	Geberit HDPE cap for butt welding, dia. 56 mm	56
364.812.16.1	Geberit HDPE cap for butt welding, dia. 63 mm	63
365.812.16.1	Geberit HDPE cap for butt welding, dia. 75 mm	75
366.812.16.1	Geberit HDPE cap for butt welding, dia. 90 mm	90
367.812.16.1	Geberit HDPE cap for butt welding, dia. 110 mm	110
368.812.16.1	Geberit HDPE cap for butt welding, dia. 125 mm	125
369.812.16.1	Geberit HDPE cap for butt welding, dia. 160 mm	160
370.812.16.1	Geberit HDPE cap for butt welding, dia. 200 mm	200

## Geberit protective cap for pipe end

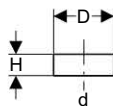

### Application Purpose

- For closing pipes
- For protecting pipe ends

### Product Details

Connecting material	HDPE
---------------------	------

### Ordering Information

Article no.	dØ [mm]	D [cm]	H [cm]	Colour
360.802.92.1	40	4,2	3,5	yellow
361.802.92.1	50	5,2	3,5	yellow
363.802.92.1	56	5,8	3,5	yellow
364.802.92.1	63	6,5	3,5	yellow
365.802.92.1	75	7,8	3,5	yellow
366.802.92.1	90	9,3	3,5	yellow
367.802.92.1	110	11,3	4	yellow
368.802.92.1	125	12,9	4	yellow
369.802.92.1	160	16,4	3	yellow

## Geberit HDPE protection plug for connection socket

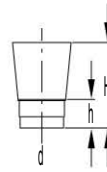

### Application Purpose

- For all drainage pipes
- For WC collar

### Ordering Information

Article no.	dØ [mm]	H [cm]	h [cm]	Colour
366.820.92.1	90	8,3	3,3	yellow
367.819.92.1	110	7,5	2,5	yellow

## Geberit loose nut adapter

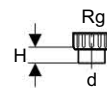

### Scope Of Delivery

- Seal

### Ordering Information

Article no.	dØ [mm]	Rg [mm/in]	H [cm]
152.178.16.1	50	60 x 1/8	3

## Geberit loose nut adapter

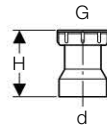

### Ordering Information

Article no.	dØ [mm]	G [']	H [cm]
152.184.16.1	32	1 1/4	2
152.175.16.1	40	1 1/4	4,5
152.176.16.1	40	1 1/2	3,5
152.179.16.1	50	1 1/4	3,3
152.180.16.1	50	1 1/2	3,3
152.181.16.1	50	2	3

### Geberit straight connector with screw connection

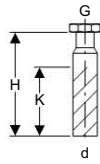

#### Product Details

Product material	PE
------------------	----

#### Scope Of Delivery

- Union nut
- Seal

#### Ordering Information

Article no.	dØ [mm]	G ["]	H [cm]	K [cm]	Colour
152.107.16.1	40	1 1/4	21	11	black
152.108.16.1	40	1 1/2	20	11	black
152.113.16.1	50	1 1/2	20	13	black
152.114.16.1	50	2	20	13	black
152.115.16.1	50	1 1/4	20	13	black

### Geberit HDPE screw cap

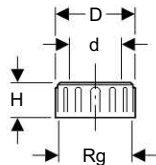

#### Application Purpose

- For all drainage pipes

#### Product Details

Product material	PP
------------------	----

#### Scope Of Delivery

- Seal EPDM

#### Ordering Information

Article no.	dØ [mm]	Rg [mm/in]	D [cm]	H [cm]
379.781.16.1	32	44 x 1/8	5,6	2,6
360.781.16.1	40	52 x 1/6	6,4	3,3
361.781.16.1	50	62 x 1/6	7,4	3,3
363.781.16.1	56	70 x 1/6	8,5	3,5
364.781.16.1	63	75 x 1/6	9	4,2
365.781.16.1	75	95 x 1/6	11,2	4,5
366.781.16.1	90	110 x 1/4	12,9	5
367.781.16.1	110	130 x 1/4	14,9	6,5

### Air admittance valves

#### Geberit air admittance valve, with thread and sleeve dia. 32 - 56 mm

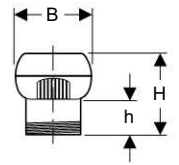
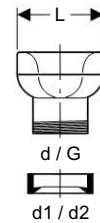
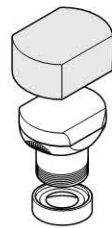

#### Application Purpose

- For ventilation of waste water pipes
- For gravity waste water systems

#### Characteristics

- Male thread 1 1/2"

#### Scope Of Delivery

- Connection sleeve
- Frost protection cover

#### Ordering Information

Article no.	dØ [mm]	d1Ø [mm]	G ["]	d2Ø [mm]	B [cm]	H [cm]	h [cm]	L [cm]
303.900.00.1	50	32	1 1/2	40	7	7,3	3,5	8

#### Geberit air admittance valve, with thread and sleeve dia. 56 - 63 mm

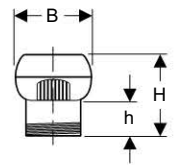
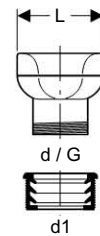

#### Application Purpose

- For ventilation of waste water pipes
- For gravity waste water systems

#### Characteristics

- Male thread 1 1/2"

#### Scope Of Delivery

- Connection sleeve
- Frost protection cover

#### Ordering Information

Article no.	dØ [mm]	d1Ø [mm]	G ["]	B [cm]	H [cm]	h [cm]	L [cm]
305.900.00.1	50	57	1 1/2	7	7,3	3,5	8



### Geberit air admittance valve, dia. 75 - 110 mm

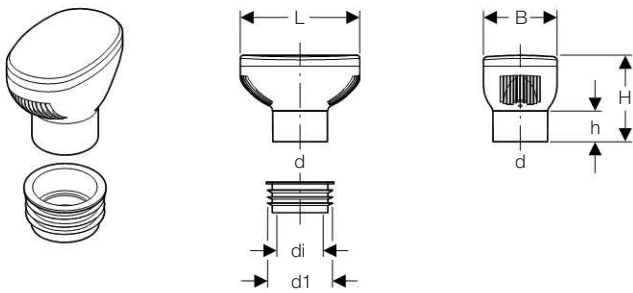

#### Application Purpose

- For ventilation of waste water pipes
- For gravity waste water systems
- Not allowed to be used as a replacement for ventilation pipes in siphon and pump pressure pipes because no ventilation through the valve is possible.

#### Characteristics

- Thermal insulation integrated in housing
- Air admittance valve type A I according to DIN EN 12380

#### Product Details

Operating temperature	-20 – +60 °C
-----------------------	--------------

#### Scope Of Delivery

- Connection sleeve

#### Ordering Information

Article no.	dØ [mm]	d1Ø [mm]	diØ [mm]	B [cm]	H [cm]	h [cm]	L [cm]
310.006.00.1	90	103,5	75	12	14,1	5	19,5

### HDPE Flanges

#### Flange

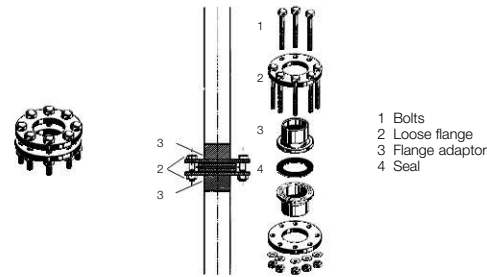

- 1 Bolts
- 2 Loose flange
- 3 Flange adaptor
- 4 Seal

#### Application Purpose

- For all drainage pipes

#### Geberit flange

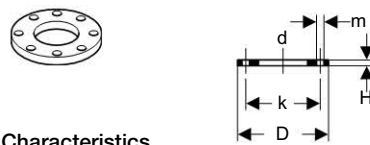

#### Characteristics

- Plastic-coated

#### Ordering Information

Article no.	dØ [mm]	D [cm]	k [cm]	m [cm]	H [cm]	n [ST]	PN [bar]
361.745.00.1	50	15	11	1,8	1,2	4	10
363.745.00.1	56 / 63	16,5	12,5	1,8	1,2	4	10
365.745.00.1	75	18,5	14,5	1,8	1,2	4	10
366.745.00.1	90	20	16	1,8	1,4	8	10
367.745.00.1	110	22	18	1,8	1,4	8	10
368.745.00.1	125	25	21	1,8	1,4	8	10
369.745.00.1	160	28,5	24	2,3	1,4	8	10
370.745.00.1	200	34	29,5	2,3	1,4	8	3,2
371.745.00.1	250	39,5	35	2,3	1,6	12	3,2
372.745.00.1	315	44,5	40	2,3	2	12	3,2

#### Geberit blind flange

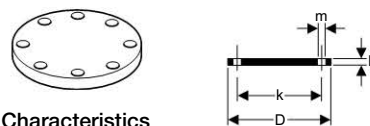

#### Characteristics

- Plastic-coated

#### Ordering Information

Article no.	dØ [mm]	D [cm]	k [cm]	m [cm]	H [cm]	n [ST]	PN [bar]
361.748.00.1	50	15	11	1,8	1,2	4	10
363.748.00.1	56 / 63	16,5	12,5	1,8	1,2	4	10
365.748.00.1	75	18,5	14,5	1,8	1,2	4	10
366.748.00.1	90	20	16	1,8	1,4	8	10
367.748.00.1	110	22	18	1,8	1,4	8	10
368.748.00.1	125	25	21	1,8	1,4	8	10
369.748.00.1	160	28,5	24	2,3	1,4	8	10
370.748.00.1	200	34	29,5	2,3	1,4	8	3,2
371.748.00.1	250	39,5	35	2,3	1,6	12	3,2
372.748.00.1	315	44,5	40	2,3	2	12	3,2

### Geberit set of bolts for flange, galvanized



#### Characteristics

- Galvanized

#### Scope Of Delivery

- Washers
- Nut

#### Ordering Information

Article no.	dØ [mm]	M [mm]	L [cm]	Product Material
361.743.26.1	50 - 75	16	7	Steel
366.743.26.1	90 - 125	16	8	Steel
369.743.26.1	160 - 200	20	9	Steel
371.743.26.1	250	20	10	Steel
372.743.26.1	315	20	11	Steel

### Geberit flange seal



#### Ordering Information

Article no.	dØ [mm]	diØ [mm]	D [cm]	H [cm]	Product Material
361.742.00.1	50	45	9,2	0,3	EPDM
363.742.00.1	56 - 63	59	10,7	0,3	EPDM
365.742.00.1	75	69	12,7	0,3	EPDM
366.742.00.1	90	83	14,2	0,3	EPDM
367.742.00.1	110	102	16,2	0,3	EPDM
368.742.00.1	125	116	19,2	0,3	EPDM
369.742.00.1	160	149	21,7	0,3	EPDM
370.742.00.1	200	191	27,2	0,3	EPDM
371.742.00.1	250	238	32,7	0,4	EPDM
372.742.00.1	315	298	37,7	0,4	EPDM

### Geberit HDPE flange adapter

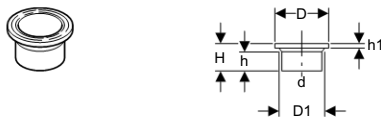

#### Ordering Information

Article no.	dØ [mm]	D [cm]	D1 [cm]	H [cm]	h [cm]	h1 [cm]	Product Material
361.744.16.1	50	8	5,4	6	4,2	0,8	HDPE
363.744.16.1	56	9	6,8	6	3,6	0,8	HDPE
364.744.16.1	63	9	6,8	6	3,7	0,8	HDPE
365.744.16.1	75	11	7,8	6,5	4	0,9	HDPE
366.744.16.1	90	12,8	9,6	7	4,4	1,1	HDPE
367.744.16.1	110	14,8	11,6	7,5	4,8	1,2	HDPE
368.744.16.1	125	16	13,1	8	5	1,4	HDPE
369.744.16.1	160	19,8	16,5	9	5,1	1,7	HDPE
370.744.16.1	200	26	20,6	7,8	5,4	1,4	HDPE
371.744.16.1	250	32,5	25,6	7,8	5,2	1,6	HDPE
372.744.16.1	315	37	31,5	10	7	2	HDPE

## HDPE Connections

### Geberit HDPE connector bend 90° with long leg for push-on seal

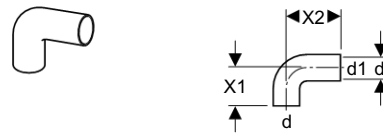

#### Application Purpose

- For all drainage pipes
- For push-on seal

#### Characteristics

- UV-resistant
- Long leg

#### Product Details

Product material	HDPE
------------------	------

#### Ordering Information

Article no.	dØ [mm]	d1Ø [mm]	diØ [mm]	X1 [cm]	X2 [cm]
361.080.16.1	50	50	44	7,5	10
363.080.16.1	56	56	50	7,5	10
363.083.16.1	56	50	44	7,5	10
364.084.16.1	56	63	57	7,5	20

### Geberit rubber collar for traps

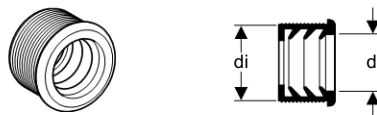

#### Ordering Information

Article no.	Description	dØ [mm]	diØ [mm]
152.682.00.1	Geberit rubber collar for traps, dia. 32 x 44 mm	32	44
152.689.00.1	Geberit rubber collar for traps, dia. 32 x 50 mm	32	50
152.690.00.1	Geberit rubber collar for traps, dia. 40 x 50 mm	40	50
152.691.00.1	Geberit rubber collar for traps, dia. 32 x 57 mm	32	57
152.692.00.1	Geberit rubber collar for traps, dia. 40 x 57 mm	40	57
152.693.00.1	Geberit rubber collar for traps, dia. 50 x 57 mm	50	57



## Geberit rubber collar for traps

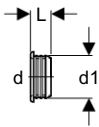

### Product Details

Product material	EPDM
------------------	------

### Ordering Information

Article no.	dØ [mm]	d1Ø [mm]	L [cm]	Colour
152.495.00.1	32	46	2,3	black
152.496.00.1	40	46	2,3	black
152.796.00.1	40	44	2,3	black
153.564.16.1	32	58	2,3	black
153.565.16.1	40	58	2,3	black
153.566.16.1	50	58	2,3	black

## Geberit HDPE double connection bend 2 x 90°

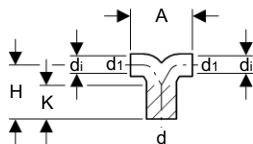

### Application Purpose

- For all drainage pipes
- For washbasins, urinals and bidets
- For push-on seal

### Characteristics

- UV-resistant

### Product Details

Product material	HDPE
------------------	------

### Ordering Information

Article no.	dØ [mm]	d1Ø [mm]	diØ [mm]	A [cm]	H [cm]	K* [cm]
363.472.16.1	56	50	44	15,5	12	3
365.472.16.1	75	56	50	15,5	13,5	9

\* K indicates the maximum shortening length

## Geberit HDPE straight adapter with shrink-fitted sleeve

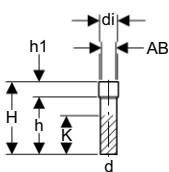

### Application Purpose

- For all drainage pipes
- For shrinking onto connection pieces and pipe ends

### Characteristics

- UV-resistant

### Product Details

Product material	HDPE
------------------	------

### Scope Of Delivery

- EPDM flat gasket
- Article no. with AB2, 1 additional lip seal EPDM

### Ordering Information

Article no.	dØ [mm]	diØ [mm]	AB1 [mm]	AB2 [mm]	H [cm]	h [cm]	h1 [cm]	K [cm]
152.651.16.1	50	60	53 - 54	48 - 49	30	24	6	17
152.197.16.1	50	70	60 - 67	53 - 60	27,5	22	5,5	17
152.198.16.1	50	80	67 - 74	60 - 67	28,5	23	5,5	17
152.652.16.1	50	90	80 - 84	73 - 77	30,5	23,5	7	17
152.654.16.1	56	60	53 - 54		26,5	20,5	6	14
152.149.16.1	56	70	60 - 67	53 - 60	24,5	19	5,5	14
152.150.16.1	56	80	67 - 74	60 - 67	24,5	19	5,5	14
152.657.16.1	63	73	60 - 67		26,5	20,5	6	14
152.658.16.1	63	80	67 - 74		26,5	19	7,5	14
152.152.16.1	75	80	67 - 74		25	19	6	12
152.151.16.1	75	90	80 - 84	73 - 77	24,5	17,5	7	12
152.661.16.1	75	100	90 - 94		28	19	9	12
366.550.16.1	90	110	84 - 98		17	7	10	0
367.551.16.1	110	125	102 - 111	100 - 109	16	6	10	0
367.550.16.1	110	140	102 - 126	100 - 124	18	8	10	0
368.550.16.1	125	150	116 - 136	115 - 134	18	8	10	1
369.550.16.1	160	195	148 - 180	149 - 176	20	8	12	1
369.551.16.1	160	230	189 - 212	187 - 220	30	12	18	5
370.550.16.1	200	230	189 - 212	187 - 220	30	13	17	2
371.550.16.1	250	280	236 - 260	234 - 250	30	13	17	2
372.550.16.1	315	355	297 - 333	295 - 323	30	14	16	2

\* K indicates the maximum shortening length





### Geberit HDPE straight connector with socket

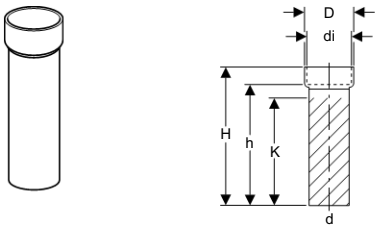

#### Application Purpose

- For all drainage pipes
- For push-on seal
- For appliances with vertical outlet

#### Characteristics

- UV-resistant

#### Product Details

Product material	HDPE
------------------	------

#### Scope Of Delivery

- Protection cap

#### Ordering Information

Article no.	dØ [mm]	diØ [mm]	D [cm]	H [cm]	h [cm]	K* [cm]
367.885.16.1	110	120	13,2	38	33	26

\* K indicates the maximum shortening length

### Geberit HDPE connector bend 88.5° with socket

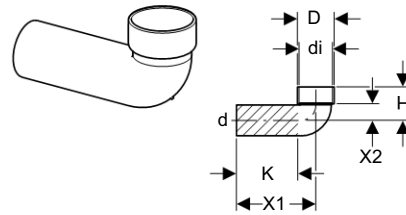

#### Application Purpose

- For all drainage pipes
- For appliances with vertical outlet

#### Characteristics

- UV-resistant

#### Product Details

Product material	HDPE
Elbow	88.5°

#### Scope Of Delivery

- Protection cap

#### Ordering Information

Article no.	dØ [mm]	diØ [mm]	D [cm]	X1 [cm]	X2 [cm]	H [cm]	K* [cm]
367.880.16.1	110	120	13,2	30	6	12	22

\* K indicates the maximum shortening length

**Geberit HDPE connector bend 88.5° with coupling and push-on seal, with raised connections on the side**

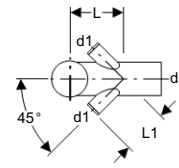
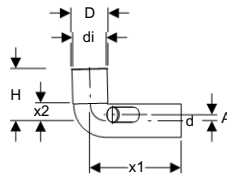
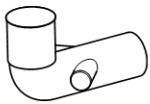

**Application Purpose**

- For all drainage pipes
- For appliances with vertical outlet

**Characteristics**

- UV-resistant
- Raised connections on the side

**Product Details**

Product material	HDPE
Elbow	88.5°

**Scope Of Delivery**

- Protection cap

**Ordering Information**

Article no.	dØ [mm]	d1Ø [mm]	diØ [mm]	D [cm]	A [cm]	X1 [cm]	X2 [cm]	H [cm]	L [cm]	L1 [cm]
367.888.16.1	110	50	110	11,6	2	30	6	17	17,5	14

**Geberit HDPE straight connector with ring seal socket**

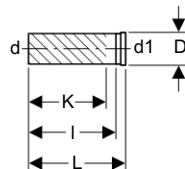

**Application Purpose**

- For all drainage pipes
- For push-on seal
- For appliances with horizontal outlet

**Characteristics**

- UV-resistant

**Product Details**

Product material	HDPE
------------------	------

**Scope Of Delivery**

- Lip seal EPDM
- Protection cap

**Ordering Information**

Article no.	dØ [mm]	d1Ø [mm]	D [cm]	L [cm]	I [cm]	K* [cm]
366.887.16.1	90	90	11,2	31	27,5	24
367.887.16.1	110	90	11,2	34,5	31,5	28

\* K indicates the maximum shortening length



### Geberit HDPE connector bend 90° with ring seal socket

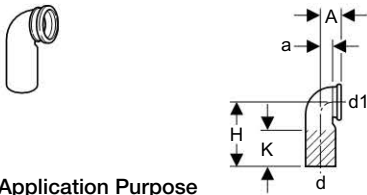

#### Application Purpose

- For all drainage pipes
- For appliances with horizontal outlet

#### Characteristics

- UV-resistant

#### Product Details

Product material	HDPE
Elbow	90°

#### Scope Of Delivery

- Lip seal EPDM
- Protection cap

#### Ordering Information

Article no.	dØ [mm]	d1Ø [mm]	A [cm]	a [cm]	H [cm]	K* [cm]
366.925.16.1	90	90	7,5	4,5	22,5	13
367.925.16.1	110	90	7,5	4,5	22,5	13
367.792.16.1	110	110	7,5	4,5	22,5	13

\* K indicates the maximum shortening length

### Geberit HDPE double bend 2 x 90° with ring seal sockets

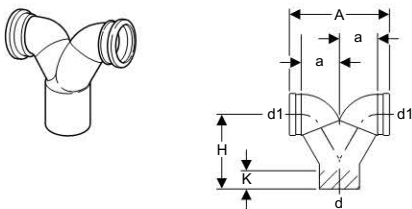

#### Application Purpose

- For all drainage pipes
- For appliances with horizontal outlet

#### Characteristics

- UV-resistant

#### Product Details

Product material	HDPE
Elbow	90°

#### Scope Of Delivery

- Lip seals EPDM
- Protection cap

#### Ordering Information

Article no.	dØ [mm]	d1Ø [mm]	A [cm]	a [cm]	H [cm]	K* [cm]
367.923.16.1	110	90	27,5	10,5	32,5	19
367.903.16.1	110	110	28,5	11	20,5	5

\* K indicates the maximum shortening length

### Geberit HDPE double connection bend 2 x 90° with ring seal sockets, offset

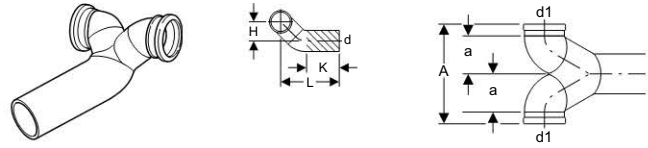

#### Application Purpose

- For all drainage pipes
- For appliances with horizontal outlet

#### Characteristics

- UV-resistant
- Offset

#### Product Details

Product material	HDPE
Elbow	90°

#### Scope Of Delivery

- Lip seals EPDM
- Protection cap

#### Ordering Information

Article no.	dØ [mm]	d1Ø [mm]	A [cm]	a [cm]	H [cm]	L [cm]	K* [cm]
367.485.16.1	110	90	27,5	10,5	10	34	12

\* K indicates the maximum shortening length

### Geberit HDPE connection ring seal socket with seal dia. 90/110 mm



#### Application Purpose

- For all drainage pipes
- For appliances with horizontal outlet
- For WC element Kombifix

#### Characteristics

- UV-resistant

#### Product Details

Product material	HDPE
------------------	------

#### Scope Of Delivery

- Lip seal EPDM
- Protection cap

#### Ordering Information

Article no.	dØ [mm]	d1Ø [mm]	D [cm]	L [cm]
366.941.16.1	90	90	11,1	4
367.941.16.1	110	90	11,1	4

### Geberit PVC S-bend dia. 90/110 mm

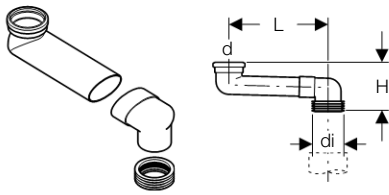

#### Application Purpose

- For all drainage pipes
- For converting floor standing WC to wall-hung WC installation

#### Product Details

Product material	PVC
------------------	-----

#### Scope Of Delivery

- Lip seal EPDM
- Rubber seal EPDM
- Adhesive PVC-U

#### Ordering Information

Article no.	dØ [mm]	diØ [mm]	H [cm]	L [cm]
388.350.29.1	90	100 - 105,6	16,7	14,5 - 34,5

### Protecting caps for weathering slates

#### Geberit HDPE protecting cap for weathering slates



#### Application Purpose

- For all drainage pipes
- For enclosing ventilation pipes

#### Characteristics

- UV-resistant

#### Product Details

Product material	HDPE
------------------	------

#### Scope Of Delivery

- Lip seal EPDM

#### Ordering Information

Article no.	dØ [mm]	D [cm]	H [cm]
364.989.16.1	63	10	7
365.989.16.1	75	12	9
366.989.16.1	90	14	10
367.989.16.1	110	17	11
368.989.16.1	125	18	12
369.989.16.1	160	23	16

### Funnel

#### Geberit funnel oval

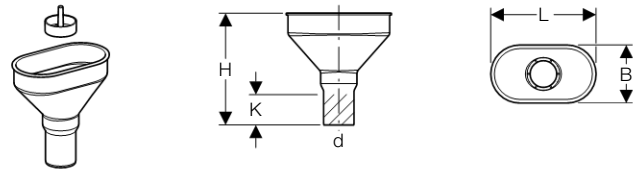

#### Scope Of Delivery

- Screen

#### Ordering Information

Article no.	dØ [mm]	B [cm]	H [cm]	L [cm]	K [cm]
352.377.16.1	40	9,5	18,5	17,5	5
352.379.16.1	50	9,5	18,5	17,5	5

\* K indicates the maximum shortening length



## Sealings for passages through wall and ceilings

### Geberit puddle flange

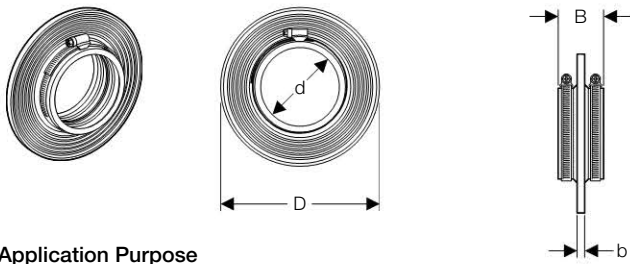

#### Application Purpose

- For covering pipe openings in walls, ceilings and floors
- For protection against moisture
- For Geberit HDPE und Geberit Silent-db20

#### Scope Of Delivery

- 2 stainless steel clamping bands

#### Ordering Information

Article no.	dØ [mm]	D [cm]	B [cm]	b [cm]
348.227.00.1	110	21	6	1
348.228.00.1	125	22,5	6	1
348.229.00.1	160	26	6	1

### Geberit moisture sealing with Resistit foil



#### Application Purpose

- For covering pipe openings in walls, ceilings and floors
- For protection against moisture
- Area of application up to 1 m water level
- For bonded connections
- For connecting elastical bitumen sealings (e.g. SBS-Bitumen)
- For hot bitumen and sealing paint
- Resistit for connection with bitumen
- Not designed for connecting with flexible bitumen seals such as Bitum APP

#### Characteristics

- Seal, EPDM
- Resistit contact foil, EPDM

#### Ordering Information

Article no.	dØ [mm]	D [cm]	H [cm]	L [cm]
361.673.00.1	50	13,5	2,5	50
363.673.00.1	56	13,5	2,5	50
365.673.00.1	75	19,5	2,5	50
366.673.00.1	90	19,5	2,5	50
367.673.00.1	110	19,5	2,5	50
368.673.00.1	125	21	2,5	50

### Geberit moisture sealing with Sarnafil foil PVC

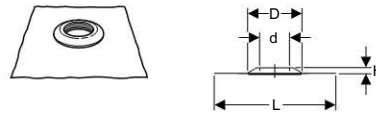

#### Application Purpose

- For covering pipe openings in walls, ceilings and floors
- For protection against moisture
- Area of application up to 1 m water level
- For welding with PVC sheet

#### Characteristics

- Sarnafil contact foil, PVC
- Seal, EPDM

#### Ordering Information

Article no.	dØ [mm]	D [cm]	H [cm]	L [cm]
361.674.00.1	50	13,5	2,5	48
363.674.00.1	56	13,5	2,5	48
365.674.00.1	75	19,5	2,5	48
366.674.00.1	90	19,5	2,5	48
367.674.00.1	110	19,5	2,5	48
368.674.00.1	125	21	2,5	48

## Fire protection sleeve

### Fire protection sleeve RS90 Plus DIN

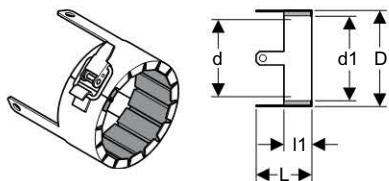

#### Application Purpose

- For Geberit HDPE und Geberit Silent-db20
- For pipe openings in walls or ceilings
- For protection against fire spread
- For waste water pipelines of dia. 40 - 200 mm
- For subsequent installation on/in ceiling, brick- or drywalls
- For direct installation on/in ceiling, brick- or drywalls
- Cannot be used for installation in bends which are already partially built into the ceiling plates

#### Characteristics

- Fire resistance S 90, R 90, EI 90
- Sound-absorbing

#### Product Details

Product material	Steel
------------------	-------

#### Scope Of Delivery

- Wedge type bolts
- Insulation against solid-borne noise
- Information plate for identification
- Adhesive tape

#### Ordering Information

Article no.	dØ [mm]	d1Ø [mm]	D [cm]	L [cm]	l1 [cm]
348.200.00.1	32 - 56	66	7,8	8,5	5
348.201.00.1	63 / 75	83	10,2	8,5	5
348.202.00.1	90	95	11,6	8,5	5
348.203.00.1	110	116	14,1	8,5	5
348.204.00.1	125 / 135	142	16,7	10,5	7
348.205.00.1	160	170	19,8	11,5	8
348.206.00.1	200	208	25,1	12,5	9

### Geberit fire protection sleeve RS90 Plus EN

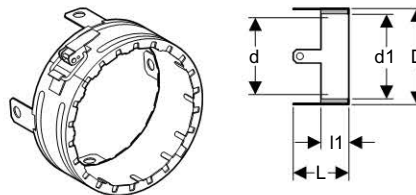

#### Application Purpose

- For protection against fire spread
- For pipe openings in walls or ceilings
- For waste water pipelines of dia. 40 - 200 mm
- For subsequent installation on/in ceiling, brick- or drywalls
- For direct installation on/in ceiling, brick- or drywalls
- Not suitable for passing other parts or aids through

#### Characteristics

- Approval in acc. with EN
- Fire resistance S 90, R 90, EI 90
- Sound-absorbing

#### Product Details

Product material	Steel
------------------	-------

#### Scope Of Delivery

- Concrete screws
- Insulation against solid-borne noise
- Adhesive tape

#### Ordering Information

Article no.	dØ [mm]	d1Ø [mm]	D [cm]	L [cm]	l1 [cm]
348.300.00.1	40 - 56	66	7,8	8,5	5
348.301.00.1	63 / 75	83	10,2	8,5	5
348.302.00.1	90	96	11,9	8,5	5
348.303.00.1	110	117	14,5	8,5	5
348.304.00.1	125 / 135	142	17	10,5	7
348.305.00.1	160	170	20,6	11,5	8
348.306.00.1	200	213	27,2	12,5	9



## Adapters for different pipe material

### Geberit HDPE adapter with female thread

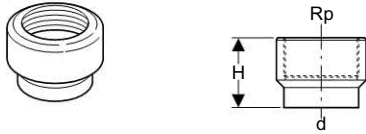

#### Application Purpose

- For all drainage pipes

#### Characteristics

- UV-resistant
- With support ring, stainless steel

#### Product Details

Product material	HDPE
------------------	------

#### Ordering Information

Article no.	dØ [mm]	Rp ["]	H [cm]
360.719.16.1	40	1/2	5,5
360.720.16.1	40	3/4	5,5
360.721.16.1	40	1	5,5
361.719.16.1	50	1/2	6
361.720.16.1	50	3/4	6
361.721.16.1	50	1	6
361.722.16.1	50	1 1/4	6
361.723.16.1	50	1 1/2	6
363.724.16.1	56	2	6,5
364.724.16.1	63	2	7
365.725.16.1	75	2 1/2	7

### Geberit HDPE adapter with male thread



#### Application Purpose

- For all drainage pipes

#### Characteristics

- UV-resistant
- With support ring, stainless steel

#### Product Details

Product material	HDPE
------------------	------

#### Ordering Information

Article no.	dØ [mm]	R ["]	H [cm]
361.726.16.1	50	1 1/4	6
361.727.16.1	50	1 1/2	6
363.728.16.1	56	2	6,5
364.728.16.1	63	2	6,5
365.729.16.1	75	2 1/2	7

### Geberit HDPE adapter connection piece with male thread and screw connection

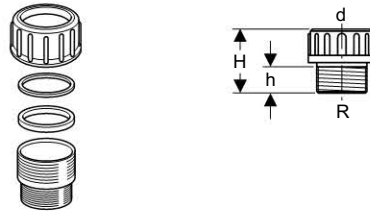

#### Application Purpose

- For all drainage pipes

#### Characteristics

- Male thread

#### Scope Of Delivery

- Union nut PP
- Slip ring PP
- Seal EPDM
- Protective cap

#### Ordering Information

Article no.	dØ [mm]	R ["]	H [cm]	h [cm]
359.309.00.1	50	1 1/2	6,5	2,7
359.311.00.1	56	2	6,5	2,7

### Geberit HDPE adapter connection piece with female thread and screw connection

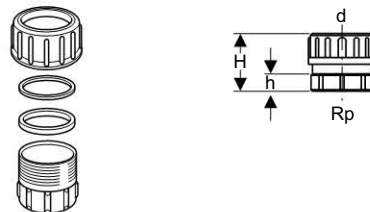

#### Application Purpose

- For all drainage pipes

#### Characteristics

- Female thread

#### Scope Of Delivery

- Union nut PP
- Slip ring PP
- Seal EPDM
- Protective cap

#### Ordering Information

Article no.	dØ [mm]	Rp ["]	H [cm]	h [cm]
359.313.00.1	56	2	6	1,8

### Geberit HDPE adapter connection piece with screw connection, for soldering, brass

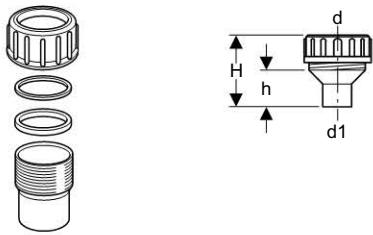

#### Application Purpose

- For all drainage pipes
- For soft and hard-soldering

#### Scope Of Delivery

- Union nut PP
- Slip ring PP
- Seal EPDM

#### Ordering Information

Article no.	dØ [mm]	d1Ø [mm]	H [cm]	h [cm]
359.330.00.1	56	54	8,3	3,5

### Geberit PVC adapter socket reduced

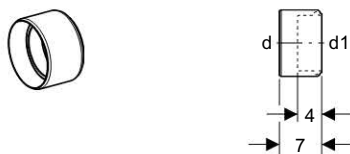

#### Application Purpose

- For stand WC
- For plugging in a PVC sleeve dia. 110 mm

#### Ordering Information

Article no.	dØ [mm]	d1Ø [mm]
152.465.00.1	110	90

### Geberit adapter HDPE / PVC

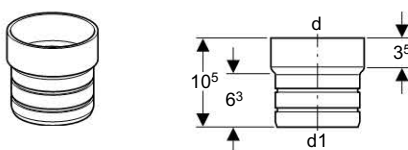

#### Application Purpose

- For all drainage pipes

#### Characteristics

- UV-resistant

#### Product Details

Product material	HDPE
------------------	------

#### Scope Of Delivery

- 2 round cord rings, EPDM

#### Ordering Information

Article no.	dØ [mm]	d1Ø [mm]	Colour
359.461.16.1	110	99	black

### Geberit adapter piece PVC

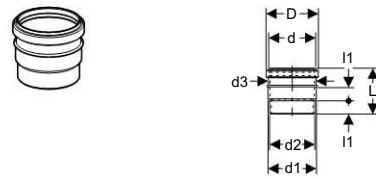

#### Ordering Information

Article no.	dØ [mm]	d1Ø [mm]	d2Ø [mm]	d3Ø [mm]	D [cm]	L [cm]	l1 [cm]
359.144.11.1	90	100	94	98	10,8	9,5	2,8

### Geberit HDPE adapter connection piece for gluing PVC, with screw connection

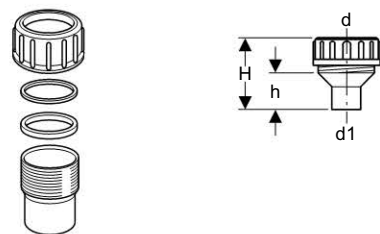

#### Application Purpose

- For all drainage pipes
- For bonding

#### Product Details

Product material	PVC
------------------	-----

#### Scope Of Delivery

- Union nut PP
- Slip ring PP
- Seal EPDM

#### Ordering Information

Article no.	dØ [mm]	d1Ø [mm]	H [cm]	h [cm]
359.421.00.1	56	50	8	4
359.423.00.1	56	63	7,8	4

### Geberit adapter piece to cast-iron

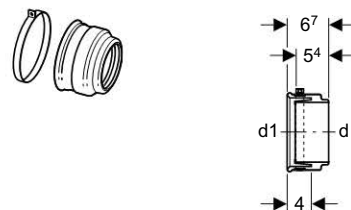

#### Product Details

Product material	EPDM
------------------	------

#### Ordering Information

Article no.	dØ [mm]	d1Ø [mm]
367.009.16.1	90	110





### Geberit adapter connection piece HDPE / cast iron

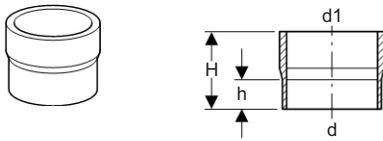

#### Application Purpose

- For all drainage pipes

#### Characteristics

- UV-resistant
- With support ring, stainless steel

#### Product Details

Product material	HDPE
------------------	------

#### Ordering Information

Article no.	dØ [mm]	d1Ø [mm]	H [cm]	h [cm]
370.738.16.1	200	212	16	8
371.738.16.1	250	274	16	11,5
372.738.16.1	315	326	16	11,5

### Geberit PE adapter connection piece for ceramic materials

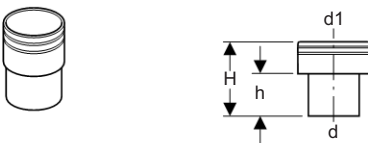

#### Application Purpose

- For all drainage pipes
- For plugging into ceramic sleeves
- For connecting pipe ends with ceramic clips
- For seals and clamping connectors for ceramic materials

#### Characteristics

- UV-resistant

#### Product Details

Product material	HDPE
------------------	------

#### Scope Of Delivery

- Seal EPDM

#### Ordering Information

Article no.	dØ [mm]	d1Ø [mm]	H [cm]	h [cm]	Colour
367.739.16.1	110	132	15,2	7	black
368.739.16.1	125	159	15,5	7	black
369.739.16.1	160	186	15,5	7	black
370.739.16.1	200	242	20	13	black
371.739.16.1	250	298	20	13	black
372.739.16.1	315	352	20	12	black

### Geberit HDPE support ring

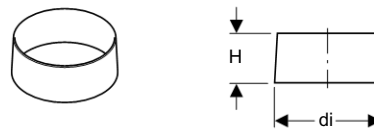

#### Application Purpose

- For all drainage pipes
- For supporting pipes and fittings HDPE, when used with clamping connector

#### Product Details

Product material	CrNi steel 1.4301 (DIN EN 10088)
------------------	----------------------------------

#### Ordering Information

Article no.	dØ [mm]	diØ [mm]	H [cm]
359.454.00.1	50	44	4
359.455.00.1	56	50	4
359.456.00.1	63	57	4
359.457.00.1	75	69	4
359.458.00.1	90	83	4
359.459.00.1	110	101,4	4
359.462.00.1	125	115,2	4
359.463.00.1	140	129,2	4
359.464.00.1	160	147,6	4

Geberit HDPE adapter clamping connector **new**

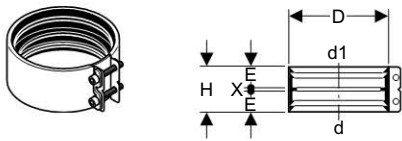

**Application Purpose**

- For all drainage pipes
- For connection pipes and fittings made of the same or different material

**Product Details**

Product material	Stainless steel
------------------	-----------------

**Scope Of Delivery**

- 2 screws
- Rubber seal EPDM
- Excluded: Support ring for PE pipes

**Ordering Information**

Article no.	dØ [mm]	d1Ø [mm]	D [cm]	E [cm]	X [cm]	H [cm]
359.424.00.2	48-50	48-50	6,3	2,7	0,3	5,7
359.425.00.2	54-56	54-56	7,5	2,7	0,3	5,7
359.426.00.2	56	58	7,5	2,7	0,3	5,7
359.427.00.2	56	68	8,3	2,7	0,3	5,7
359.428.00.2	63	60	7,8	2,7	0,3	5,7
359.429.00.2	63-64	63-64	7,8	2,7	0,3	5,7
359.430.00.2	63-64	68	8,3	2,7	0,3	5,7
359.431.00.2	68	68	8,3	2,6	0,4	5,6
359.432.00.2	75	68	9	2,7	0,3	5,7
359.433.00.2	75-76	75-76	8,8	2,7	0,3	5,7
359.434.00.2	75-76	78	9,3	2,7	0,3	5,7
359.435.00.2	75-76	83-84	9,8	2,7	0,3	5,7
359.436.00.2	75-76	89-90	10,3	2,7	0,3	5,7
359.437.00.2	89-90	83-84	11,1	2,7	0,3	5,7
359.438.00.2	89-90	89-90	10,3	2,7	0,3	5,7
359.439.00.2	89-90	96	11,1	3,3	0,3	6,9
359.440.00.2	108-110	106	12,5	2,7	0,3	5,7
359.441.00.2	108-110	108-110	12,5	2,7	0,3	5,7
359.442.00.2	108-110	114-116	13,1	3,3	0,3	6,9
359.443.00.2	125	125	14	2,7	0,3	5,7
359.444.00.2	125	131-135	15	3,3	0,3	6,9
359.445.00.2	125	140-141	15,6	3,3	0,3	6,9
359.446.00.2	135	135	15	3,3	0,3	6,9
312.140.00.2	135	140	15,5	3,1	0,7	6,9
359.447.00.2	140-141	140-141	15,5	3,3	0,3	6,9
359.448.00.2	159-160	152	17,5	3,3	0,3	6,9
359.449.00.2	159-160	159-160	17,5	3,3	0,3	6,9
359.450.00.2	159-160	168	18,3	3,3	0,3	6,9
359.451.00.2	210	210	22,5	3,3	0,3	6,9

**Note:**

To be used with Geberit HDPE support ring.

Conventional roof drainage

Geberit conventional roof outlet, with fastening flange

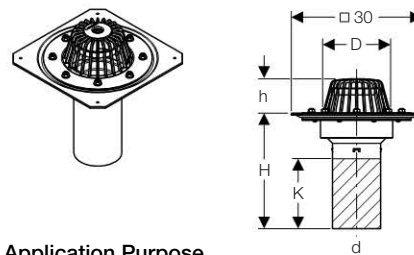

**Application Purpose**

- For connecting plastic roof foils
- Must not be used for bitumen roof foils

**Characteristics**

- Maintenance-free clamping flange connection

**Product Details**

Drainage capacity max.	7 l/s
------------------------	-------

**Scope Of Delivery**

- Foil fastening flange with gasket and nuts

**Ordering Information**

Article no.	dØ [mm]	D [cm]	H [cm]	h [cm]	K [cm]
359.013.00.1	110	16	26,5	8	14

Geberit roof outlet for bitumen

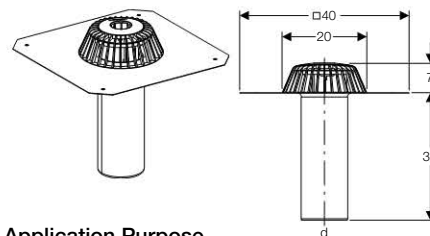

**Application Purpose**

- For connecting with bitumen roof foils
- For collecting and draining of rainwater on roofs
- For conventional rainwater drainage

**Characteristics**

- Vertical outlet
- Straight connector made of chrome nickel steel 1.4301
- Outlet pipe cuttable

**Product Details**

Maximum head of water	35 mm
Drainage capacity max.	6 (d110) / 5,5 (d90) l/s

**Scope Of Delivery**

- Outlet grating made of PP
- Base unit with contact sheet made of chrome nickel steel 1.4301
- Protective cap

**Ordering Information**

Article no.	Description	dØ [mm]
359.037.00.1	Geberit roof outlet for bitumen, d110	110
359.038.00.1	Geberit roof outlet for bitumen, d90	90



### Geberit supplementary set for roof outlet, suitable for promenade decks

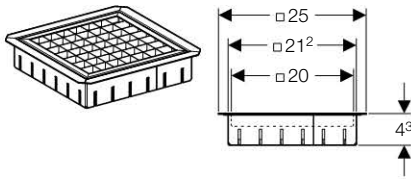

#### Application Purpose

- For collecting and draining of rainwater on roofs
- For conventional rainwater drainage
- For use with Geberit roof outlet for bitumen roof foil

#### Characteristics

- Load bearing capacity up to 150 kg

#### Scope Of Delivery

- Grating made of chrome nickel steel 1.4301
- Grating frame made of chrome nickel steel 1.4301

#### Ordering Information

Article no.	Description
359.039.00.1	Geberit supplementary set for roof outlet, suitable for promenade decks

### Geberit vertical connection set

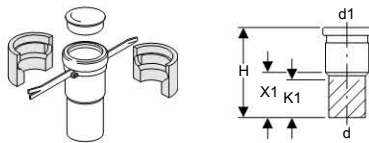

#### Application Purpose

- For outlet element

#### Scope Of Delivery

- Anti-condensation insulation
- Fastening material
- Protection cap

#### Ordering Information

Article no.	dØ [mm]	d1Ø [mm]	X1 [cm]	H [cm]	K1 [cm]
366.979.00.1	90	90	14	26,5	11
367.979.00.1	110	110	14	26,5	11

### Geberit horizontal connection set

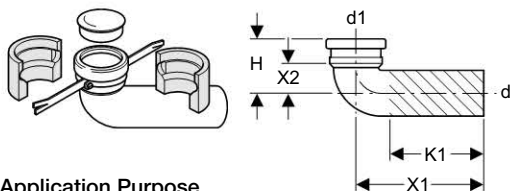

#### Application Purpose

- For outlet element

#### Ordering Information

Article no.	dØ [mm]	d1Ø [mm]	X1 [cm]	X2 [cm]	H [cm]	K1 [cm]
366.980.00.1	90	90	27	5,5	9,5	20
367.980.00.1	110	110	30	8	13	22

### Geberit HDPE trap with expansion socket and round inspection opening

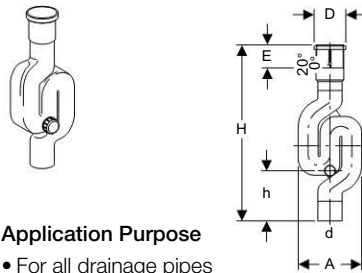

#### Application Purpose

- For all drainage pipes

#### Characteristics

- UV-resistant
- With expansion socket
- With cleaning opening

#### Product Details

Product material	HDPE
Depth of water seal	70 mm

#### Scope Of Delivery

- Sealing cap PP
- Seal EPDM
- Lip seal EPDM
- Protection cap

#### Ordering Information

Article no.	dØ [mm]	D [cm]	A [cm]	E [cm]	H [cm]	h [cm]
365.813.16.1	75	10,5	19,8	7 - 10,5	65,5	16,7
367.813.16.1	110	14,4	28,8	7 - 10,5	80	22,8

## Fastenings

### Geberit adjustable pipe bracket, with threaded nut G1/2, for fixed-point welding strip

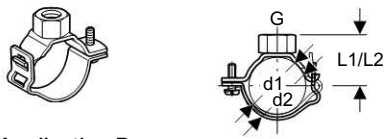

#### Application Purpose

- For fastening pipes on ceilings and for vertical fastening on walls
- For slide fastening of pipes
- For anchor-point fastening in combination with electrofusion tapes
- For fastening with threaded rod

#### Characteristics

- Female thread
- Galvanized
- Adjustable

#### Ordering Information

Article no.	d1Ø [mm]	G ["]	d2Ø [mm]	L1 [cm]	L2 [cm]
360.841.00.2	40	1/2	48	3,5	3,9
361.841.00.2	50	1/2	58	4	4,4
363.841.00.2	56	1/2	64	4,3	4,7
364.841.00.2	63	1/2	71	4,7	5,1
365.841.00.2	75	1/2	83	5,3	5,7
366.841.00.2	90	1/2	98	6	6,4
367.841.00.2	110	1/2	118	7	7,4
368.841.00.2	125	1/2	133	7,8	8,2
369.841.00.2	160	1/2	168	9,5	9,9

### Geberit pipe bracket Kombi with coupling M10, adjustable



#### Application Purpose

- For fastening pipes on ceilings and for vertical fastening on walls
- For slide fastening of pipes
- For fastening with threaded rods
- For anchor-point fastening in combination with electrofusion tapes

#### Characteristics

- Female thread
- Galvanized
- Adjustable

#### Ordering Information

Article no.	d1Ø [mm]	M [mm]	d2Ø [mm]	L1 [cm]	L2 [cm]
360.843.00.2	40	10	48	3,5	3,9
361.843.00.2	50	10	58	4	4,4
363.843.00.2	56	10	64	4,3	4,7
364.843.00.2	63	10	71	4,7	5,1
365.843.00.2	75	10	83	5,3	5,7
366.843.00.2	90	10	98	6	6,4
367.843.00.2	110	10	118	7	7,4
368.843.00.2	125	10	133	7,8	8,2
369.843.00.2	160	10	168	9,5	9,9

### Geberit pin screw M10



#### Characteristics

- Male thread

#### Ordering Information

Article no.	Description	L [cm]
362.833.00.1	Geberit pin screw M10	10

### Geberit mounting plate round 3-hole, with coupling M10

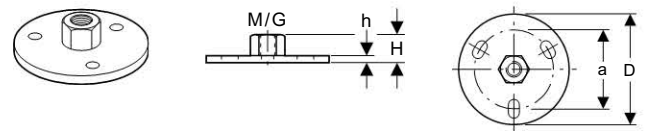

#### Application Purpose

- For slide fastening
- For fastening pipes on ceilings and for vertical fastening on walls
- For attaching pipe brackets to the building structure
- For attaching support rails to the building structure

#### Characteristics

- Female thread
- 3 fastening points

#### Ordering Information

Article no.	M [mm]	D [cm]	a [cm]	H [cm]	h [cm]
362.837.26.1	10	7	5	1,6	0,4

### Geberit mounting plate round 3-hole, with coupling G1/2"

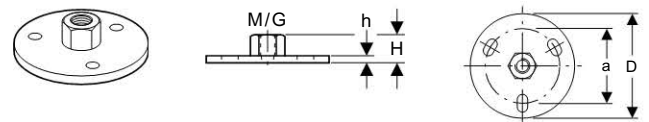

#### Application Purpose

- For fastening pipes on ceilings and for vertical fastening on walls
- For attaching pipe brackets to the building structure
- For anchor-point and slide fastening

#### Characteristics

- Female thread
- 3 fastening points

#### Ordering Information

Article no.	G ["]	D [cm]	a [cm]	H [cm]	h [cm]
362.839.26.1	1/2	7	5	1,9	0,4



### Geberit mounting plate with threaded nut 1/2"

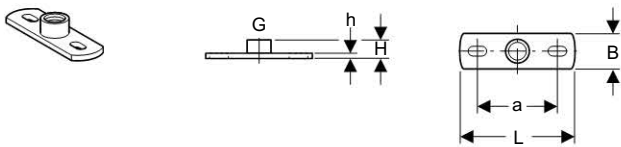

#### Application Purpose

- For anchor-point and slide fastening
- For fastening pipes on ceilings and for vertical fastening on walls
- For attaching pipe brackets to the building structure

#### Characteristics

- Female thread
- 2 fastening points

#### Ordering Information

Article no.	G ["]	a [cm]	B [cm]	H [cm]	h [cm]	L [cm]
362.826.26.1	1/2	9	4	2,1	0,6	12

### Geberit mounting plate angular 2-hole, with socket M8/M10

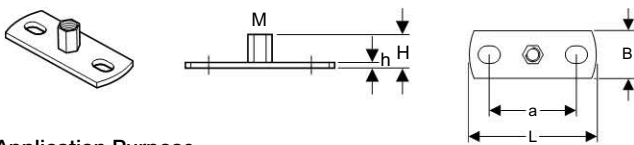

#### Application Purpose

- For slide fastening
- For attaching support rails to the building structure

#### Characteristics

- Galvanized
- Female thread
- 2 fastening points

#### Ordering Information

Article no.	M [mm]	a [cm]	B [cm]	H [cm]	h [cm]	L [cm]
362.848.26.1	8 / 10	5,4	3	1,9	0,3	8

### Geberit threaded rod



#### Application Purpose

- For fastening of support rails on mounting plate
- For fastening pipes on mounting plate

#### Characteristics

- Male thread

#### Scope Of Delivery

- PVC sleeve

#### Ordering Information

Article no.	M [mm]	L [cm]
362.836.00.1	10	50

### Geberit plastic strip for pipe bracket



#### Application Purpose

- For guide brackets in conjunction with pipe brackets

#### Product Details

Product material	PE-LD
------------------	-------

#### Ordering Information

Article no.	Description
362.846.00.1	Geberit plastic strip for pipe bracket, dia. 40 - 160 mm
370.846.00.1	Geberit plastic strip for pipe bracket, dia. 200 - 315 mm

### Geberit support shell galvanized and coated

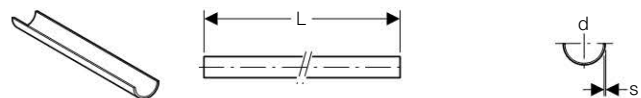

#### Characteristics

- Coated
- Galvanized

#### Ordering Information

Article no.	dØ [mm]	s [mm]	L (m) [m]
360.850.00.1	40	0,75	3
361.850.00.1	50	0,75	3
363.850.00.1	56	0,75	3
364.850.00.1	63	0,75	3
365.850.00.1	75	0,75	3
366.850.00.1	90	0,75	3
367.850.00.1	110	0,75	3
368.850.00.1	125	0,75	3

### Geberit pipe bracket Super, with threaded nut M8/M10

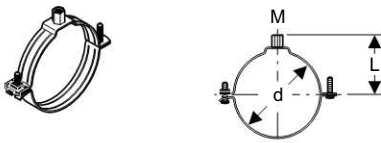

#### Application Purpose

- For fastening pipes on ceilings and for vertical fastening on walls
- For fastening with threaded rods
- Not suitable for the slide fastening of pipes

#### Characteristics

- Female thread
- Galvanized
- Threaded fastening M8/M10

#### Ordering Information

Article no.	dØ [mm]	M [mm]	L [cm]
360.832.00.2	40	8 / 10	4,3
361.832.00.2	50	8 / 10	4,8
363.832.00.2	56	8 / 10	5,1
364.832.00.2	63	8 / 10	5,5
365.832.00.2	75	8 / 10	6,1
366.832.00.2	90	8 / 10	6,8
367.832.00.2	110	8 / 10	7,8
368.832.00.2	125	8 / 10	8,6
369.832.00.2	160	8 / 10	10,3

#### Note:

Not to be used as anchor bracket.

### Geberit double flange bushing

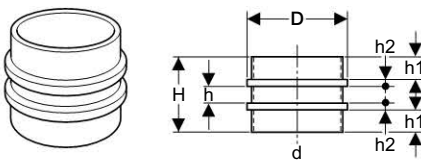

#### Application Purpose

- For anchor brackets

#### Product Details

Product material	PE
------------------	----

#### Ordering Information

Article no.	dØ [mm]	D [cm]	H [cm]	h [cm]	h1 [cm]	h2 [cm]	Colour
370.751.16.1	200	21,3	19,1	4,1	6	1,5	black
371.751.16.1	250	26,2	20,1	4,1	6	2	black
372.751.16.1	315	32,6	20,1	4,1	6	2	black

### Geberit bracket, with threaded nut 1"

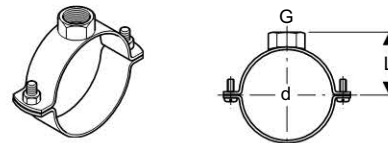

#### Application Purpose

- For fastening pipes on ceilings and for vertical fastening on walls
- For guide brackets in conjunction with plastic insert strips
- For anchor-point fastening of pipes in conjunction with electrofusion sleeve couplings or double flange bushings
- For fastening with threaded rod

#### Characteristics

- Female thread
- Galvanized
- Pipe bracket width 4 cm

#### Product Details

Product material	Steel
------------------	-------

#### Ordering Information

Article no.	dØ [mm]	G ["]	L [cm]
370.840.00.1	200	1	14,8
371.840.00.1	250	1	17,3
372.840.00.1	315	1	20,5

### Geberit mounting plate angular 2-hole, with coupling G1"

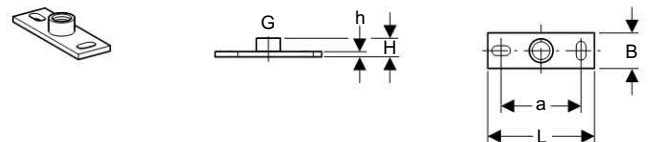

#### Application Purpose

- For fastening pipes on the building structure
- For fastening pipes on ceilings and for vertical fastening on walls
- For anchor-point and slide fastening

#### Characteristics

- Galvanized
- Female thread
- 2 fastening points

#### Product Details

Product material	Steel
------------------	-------

#### Ordering Information

Article no.	G ["]	a [cm]	B [cm]	H [cm]	h [cm]	L [cm]	Colour
362.828.26.1	1	9	4	2,6	0,6	12	galvanized